

FOURTH YEAR.

TWIN FALLS NEWS, TWIN FALLS, IDAHO, FRIDAY, MAY 8, 1908.

NUMBER 28

RIVERSIDE INN PROVES POPULAR

HANDSOME HOSTELRY LIBERALLY PATRONIZED.

Musical and Dancing Enjoyed by the Crowd on the Opening Evening. Land Owners in the First Segregation Are Flocking in.

MILNER, Ida., May 7.—Last Friday Riverside Inn was opened to the public and all who have since stopped there have gained its success with the stamp of their approval. In the evening there was music and dancing which was enjoyed by a good sized crowd. Everything was bright and attractive, the electric light coming up to all expectations. The dining room is cozy and the meals served are excellent. The wide veranda overlooking the falls affords a most delightful resting place. Arnold Frankell presides at the desk in a most genial manner, with a smile and pleasant word for every guest.

Mrs. R. S. Fensenden, Miss Jane Douglas and R. T. McNamara of the North side spent Tuesday in Twin Falls.

Born, Saturday, May 2nd, to Mr. and Mrs. W. B. Wheeler, a daughter, Major Fred R. Reed spent Friday and Saturday in Milner, attending the opening of Riverside Inn.

Mrs. A. Clements went to Twin Falls Monday to visit friends for a few days.

D. MacWaters, R. H. Schenckel and P. S. A. Bickel returned Saturday from a business trip to Boise.

Miss Edith Bennett of Burley was the guest of friends in Milner Friday and Saturday.

Mr. and Mrs. E. M. Bennett, Misses Alice Hendricks, Mary, Coburn, Lillian Bennett and E. A. Bakke went to Burley Saturday to spend Sunday with friends.

Misses Florence Ottley and Alice Robinson left Monday for their home in Elko.

Mrs. O. R. Petterson of Burley spent Wednesday night in Milner enroute to Jerome where she will spend the summer.

J. D. Haughey, who has been on out of the survey crew near Buhl for several weeks, spent a few days in Milner this week.

H. S. Geary of the Milner State bank transacted business in Twin Falls on Jerome Saturday and Sunday.

Mrs. Edna West of Altman, Colorado, is visiting her parents, Mr. and Mrs. Scott Murray at their ranch on the first segregation.

L. H. Galiery of the Milner dairy has the guest of friends in Rupert over Sunday.

R. H. Schenckel was a Twin Falls business visitor Sunday and Monday of this week.

D. MacWaters was transacting business in Twin Falls Tuesday afternoon.

Arnold Frankell of Riverside Inn was calling on friends and transacting business in Twin Falls Monday.

W. Travin has moved his Boston Bargain store into the property at the corner of Third and Locust streets and is now ready for business at that location.

C. E. Milner of Salt Lake City, was the guest of Arnold Frankell at Riverside Inn over Sunday.

Mrs. George Hunt of Burley is the guest of Mrs. Frank Webb at Riverside avenue this week.

Pontreng Hill, who has been in Oregon on a business trip of some weeks, returned to Milner Sunday. Mr. Hill left again for the east Monday evening where he will remain for some time.

E. S. Smith and Mrs. J. A. Johnson of Hays are transacting business in Milner Wednesday.

E. H. Williams is erecting a residence on his lot near the South side Main street canal bridge.

Robert Brose of Rock Creek was looking after business interests in Milner this week.

The Ladies' club met with Mrs. C. B. Smith this week. Next Wednesday they will meet with Mrs. MacWaters at Riverside Inn.

Reed of Boise will hold services in Milner hall Sunday morning and evening.

Ned Bolles, W. B. Napton and J. T. Woodcock are hauling large daily consignments of seed grain from Murrah and their farms on the first segregation.

C. B. Smith left Tuesday evening for Shoshone on some engineering work.

J. M. Grimm transacted business in Twin Falls Tuesday and Wednesday of this week.

J. C. Porterfield of the Paris-Keel company was in Milner Monday.

J. E. Bradley, who has been with the Paris-Keel company for the last year, left Saturday night for Portland, where he will be employed as mail clerk on the Oregon Short Line railway.

F. P. Van Hook and wife of Boise

GOOD PRICES FOR KIMBERLY FARMS

SEVERAL CHANGE HANDS DURING THE WEEK.

Growing Demand for Town Property. Merchants to Put Incandescent Lamps in Front of Their Stores. Electric Flour Mill in Operation.

KIMBERLY, Ida., May 6.—The ice wagon has this appearance so it must be close to summer time and we get out of coal bins to pay the ice man.

Morgan O. Heap loaded out a car of fat hogs the last of the week for Oregon. He has no more stock yards yet we cannot keep from shipping out through the warehouse.

Claude C. Parks has leased his ranch to Alex Wilkins and A. L. Towle for the season. Mr. Parks has qualified for road overseer for Kimberly district and is repairing the bridges and roads which were in need of the same very much.

Three adjoining ranches just west of town, sold last week. Geo. Luff sold 40 acres to Henry Knutsen for \$100 per acre; land being in sagebrush. Carl B. Moore sold his 40 just west of the latter for \$100 per acre to Luther C. Remel. Mr. Moore will remain on the place this season. J. W. Parker sold his quarter section just west of Mr. Moore's for \$86 per acre. Mr. Parker will have a auto soon, and Mr. Allen has rented the place and is tending the crop for this year.

Several Kimberly people attended the Bicks and Lockridge sale north of Hanks Tuesday. Not as large crowd was in attendance as usual, owing to the busy times now.

Walter R. Graham of Grand Junction, Colorado, has been placed in charge of the Kimberly-Pharmacy by A. W. Peterson of Twin Falls, the proprietor. He has put in a soda fountain and will serve drinks and ice cream, as well as having a complete line of drugs. People can now get what they want here as cheap as anywhere and save much time on the road. Mr. Graham will soon be another addition to Kimberly.

D. C. Pouts of Lanark, Illinois, visited Mr. Thomas asking for advice on residence lots and business lots and says he has a party who is thinking of coming here to start a bakery and a bath.

The shade trees are all set out and the sagebrush is disappearing on the townsite, a welcome transition to the people here.

It is turning out quite a lot of ground feed for the farmers around town and the dairy cows will all get fat now.

Bill Little is superintending the 320 acres of fat wheat owned by Mr. Carter and others southeast of town. He has several hands at work irrigating it and the crop looks fine.

W. F. Thoms was in Payette on business the first part of the week. The Commercial club met Friday night and the light committee reported each business house has placed its decent lights before their place of business instead of having no lights on the street at present.

W. F. Brecken is visiting in Payette this week and attending the Woodmen convention.

C. C. Parks and J. N. Clyde expect to leave in a few days to cruise the Salmon project. Quite a number of people around Kimberly are waiting for the opening and expect to file on land then.

The young people of town report a delightful party given by Mr. and Mrs. F. M. Keen on Wednesday evening. About 150 were present and took part in the games, contests, etc. In the word contest Miss E. Pettibone won the booby prize for the fewest words. Lunch was served at a late hour and everyone departed praising Mr. and Mrs. Kendall for their royal entertainment.

John L. Barr of Denver, Colorado, was here Wednesday. Mr. Barr is president and manager of the F. C. A. Y. M. C. of Denver, and came out to see the country. He decided to much grain and of such good quality. He bought a great many years last fall that were shipped him from Kimberly. He is very favorable impressed with the future prospects of Kimberly and is trying to get a site for an elevator. The last seen of him was on the way to the town manager to get prices on lots here.

W. M. Black, who has been manager of the Western lumber yard at Kimberly the past 18 months, has been offered the same position by the same company at Twin Falls. Mr. Black has built up a good business here and his many friends regret very much to see him leave Kimberly to take a larger salary and better yard.

People here were greatly shocked to learn of the death of Mr. A. Dunham, which occurred on Wednesday night. His friends here in town did not know that she was sick, as she has been living on their homestead east of Rock Creek the past few months.

John Morell sold 80 acres to Mrs. Keith for \$50 per acre.

The baseball game on Sunday between Hanks and Kimberly resulted in a victory for Kimberly by a score of 11 to 1. Only seven players were on the field and Hanks was coming strong at the finish. Postmaster Rose umpired the game and T. J. Rauch scored.

John Morell sold 80 acres to Mrs. Keith for \$50 per acre.

The baseball game on Sunday between Hanks and Kimberly resulted in a victory for Kimberly by a score of 11 to 1. Only seven players were on the field and Hanks was coming strong at the finish. Postmaster Rose umpired the game and T. J. Rauch scored.

John Morell sold 80 acres to Mrs. Keith for \$50 per acre.

The baseball game on Sunday between Hanks and Kimberly resulted in a victory for Kimberly by a score of 11 to 1. Only seven players were on the field and Hanks was coming strong at the finish. Postmaster Rose umpired the game and T. J. Rauch scored.

John Morell sold 80 acres to Mrs. Keith for \$50 per acre.

The baseball game on Sunday between Hanks and Kimberly resulted in a victory for Kimberly by a score of 11 to 1. Only seven players were on the field and Hanks was coming strong at the finish. Postmaster Rose umpired the game and T. J. Rauch scored.

John Morell sold 80 acres to Mrs. Keith for \$50 per acre.

The baseball game on Sunday between Hanks and Kimberly resulted in a victory for Kimberly by a score of 11 to 1. Only seven players were on the field and Hanks was coming strong at the finish. Postmaster Rose umpired the game and T. J. Rauch scored.

John Morell sold 80 acres to Mrs. Keith for \$50 per acre.

The baseball game on Sunday between Hanks and Kimberly resulted in a victory for Kimberly by a score of 11 to 1. Only seven players were on the field and Hanks was coming strong at the finish. Postmaster Rose umpired the game and T. J. Rauch scored.

John Morell sold 80 acres to Mrs. Keith for \$50 per acre.

The baseball game on Sunday between Hanks and Kimberly resulted in a victory for Kimberly by a score of 11 to 1. Only seven players were on the field and Hanks was coming strong at the finish. Postmaster Rose umpired the game and T. J. Rauch scored.

John Morell sold 80 acres to Mrs. Keith for \$50 per acre.

JEROME COUNTRY CLUB ORGANIZED

MEMBERS CONTRIBUTE LIBERALLY TO ITS SUPPORT.

Tennis Court Will Be the First For the Club. Main Street Buildings Going Up on Main Street—Many Shade Trees Are Planted.

JEROME, Ida., May 5.—Fred W. Hastings and Ira Anderson were visitors from Wendell Monday.

Mrs. J. C. Golden and children left for Twin Falls Thursday where they will visit Mr. Golden.

Mr. Hale made a business trip to Milner Monday.

Paul R. Kartze and wife arrived from Burley Wednesday with their household goods and are established for the summer in their cottage on Lincoln avenue.

Joseph Krivanek has joined the Shortport camp of engineers.

The business building of Napton Bros. is just about completed and the first installment of goods is expected Tuesday.

C. L. Chapin entertained a few of his friends at cards in his room at the bank Wednesday evening. High five was the game played; Miss E. L. Covell and J. M. Hale securing the highest score capturing the prize pot of candy and a bottle of grape juice while the consolation prize was bestowed to Harvey Hurlbush.

C. W. Young, while here last week, purchased a residence here and will proceed to build and move his family here, as soon as possible.

Both Jerome and Wendell are being beautified with trees, quite a number having been set out.

Burt Haddock, one of the new settlers, is making quite extensive improvements in his land south of town. He has a 60-barrel cistern about completed and will probably be forwarded and ready for a fall crop. Good house to replace the shack he is at present occupying will be the next improvement.

Paul Haddock, one of Tacoma, Washington, has opened up a barber shop and full bearders are no longer the style in Jerome. As soon as a suit of clothes will probably be forwarded and ready for a fall crop. Good house to replace the shack he is at present occupying will be the next improvement.

The contest case brought by H. L. Owens against the 320-acre desert claim of town H. D. Cook is now being heard in Shoshone Tuesday before U. S. Land Commissioner Disney and has been referred to the office in Washington for decision. Contest was brought on the grounds that Mr. Barry was not a resident of Idaho. Mr. Barry testified that he expected to leave Idaho this year and was closing up his business in Chicago as rapidly as practicable for that purpose. Sweeley & Sweeley of Twin Falls represent the plaintiff and Stocklander & Bowen the defendant.

Main street is assuming quite the appearance of a city thoroughfare. Four new buildings are for course of construction. Two of which, the office of the Ostrander-Reed Lumber Co. and the general store building of Napton Bros. are nearing completion. Just at the corner of town H. D. Cook is putting up a good sized house, on the claim of E. L. Evans of Meadow Grove, Neb.

The high wind Sunday prevented the work of clearing the ball grounds. It also laid low one of Dr. Piper's tents.

Kartze & Co. will begin Monday the construction of a three-room house for E. G. Reed on one of the streets facing the park. Mr. Reed expects his family as soon as his house is ready.

Over a hundred trees are being set out in Gooding. These with the beautiful trees already there will make Gooding one of the most attractive towns in southern Idaho.

A. S. Hoovey has about completed the corrections in the town survey and the grades of the streets are now established. Wendell is next on the schedule.

On Wednesday evening a meeting was held at the land office building for the purpose of organizing a grounds club. The name of "The Jerome Country Club" was chosen and the following officers elected: E. G. Reed, president; Miss E. L. Covell, secretary; and C. H. Chapin, treasurer. A committee consisting of Paul Kartze, H. L. Owens and C. H. Chapin was appointed to look up a location for suitable grounds, a tennis court being one of the first things to be considered. C. H. Chapin was also appointed to solicit funds. E. G. Reed started the subscription with \$20 on behalf of the Ostrander-Reed Lumber Co. and the promise of what lumber would be necessary for a small pavilion. Kartze & Co. subscribed \$10 and the labor necessary for the same. The town of Twin Falls North Side Realty Co. \$10 and the use of team and wagon. Owens, Nowell, Chapin, Hurlbush, Smith and others contributed quite a liberally and the fund was swelled to goodly proportions by the following night. There is no reason why Jerome should not support a grounds club and the prospect of it is fairly promising. The next meeting will be held at the office of the

CERTIFIED CHECKS ARE NECESSARY.

For the Salmon opening the company will require that a properly certified check be filed with each application for land and in no instance will this rule be deviated from.

The check must call for the first payment on the acreage desired by the applicant and this acreage will be paid in full by the applicant. It is increased though it may be diminished if the applicant so wishes.

For instance, if an applicant desires to file upon 100 acres, he will deposit with his application a certified check for \$250.00. Should he decide to take only 40 acres, he will have the balance of the \$250.00 balance of \$390.00 will be refunded to him. On the other hand, should he apply for 40 acres and decide to take a check for \$131.60, and after his number is drawn, desire to file on 160 acres, his request will be rejected and he will have to re-apply for the acreage called for in his original application. However, should it happen that after the drawing there is vacant land adjoining that upon which he has filed, he will have the right to increase his filing to 160 acres or to make another filing under another power of attorney on other land.

Each and every instance the check must be certified and which it is intended as a first payment.

Twin Falls North Side Realty Co. Wednesday evening.

Mr. Arthur Eriart, recently from Miss. has purchased a new \$125 grubbier and is in the market for grubbing on a wholesale scale.

The Ostrander-Reed Lumber Co. has received the first consignment of fence posts. C. A. Pratt was the contractor for hauling them from Shoshone.

Word was received today that E. J. Ostrander and family would leave for their new home in Twin Falls next Tuesday.

Mrs. and Mrs. Earl Fee and Mr. and Mrs. James L. Mont spent Saturday and Sunday in Twin Falls.

Paul Haddock, one of Tacoma, Washington, has opened up a barber shop and full bearders are no longer the style in Jerome. As soon as a suit of clothes will probably be forwarded and ready for a fall crop. Good house to replace the shack he is at present occupying will be the next improvement.

The contest case brought by H. L. Owens against the 320-acre desert claim of town H. D. Cook is now being heard in Shoshone Tuesday before U. S. Land Commissioner Disney and has been referred to the office in Washington for decision. Contest was brought on the grounds that Mr. Barry was not a resident of Idaho. Mr. Barry testified that he expected to leave Idaho this year and was closing up his business in Chicago as rapidly as practicable for that purpose. Sweeley & Sweeley of Twin Falls represent the plaintiff and Stocklander & Bowen the defendant.

Main street is assuming quite the appearance of a city thoroughfare. Four new buildings are for course of construction. Two of which, the office of the Ostrander-Reed Lumber Co. and the general store building of Napton Bros. are nearing completion. Just at the corner of town H. D. Cook is putting up a good sized house, on the claim of E. L. Evans of Meadow Grove, Neb.

The high wind Sunday prevented the work of clearing the ball grounds. It also laid low one of Dr. Piper's tents.

Kartze & Co. will begin Monday the construction of a three-room house for E. G. Reed on one of the streets facing the park. Mr. Reed expects his family as soon as his house is ready.

Over a hundred trees are being set out in Gooding. These with the beautiful trees already there will make Gooding one of the most attractive towns in southern Idaho.

A. S. Hoovey has about completed the corrections in the town survey and the grades of the streets are now established. Wendell is next on the schedule.

On Wednesday evening a meeting was held at the land office building for the purpose of organizing a grounds club. The name of "The Jerome Country Club" was chosen and the following officers elected: E. G. Reed, president; Miss E. L. Covell, secretary; and C. H. Chapin, treasurer. A committee consisting of Paul Kartze, H. L. Owens and C. H. Chapin was appointed to look up a location for suitable grounds, a tennis court being one of the first things to be considered. C. H. Chapin was also appointed to solicit funds. E. G. Reed started the subscription with \$20 on behalf of the Ostrander-Reed Lumber Co. and the promise of what lumber would be necessary for a small pavilion. Kartze & Co. subscribed \$10 and the labor necessary for the same. The town of Twin Falls North Side Realty Co. \$10 and the use of team and wagon. Owens, Nowell, Chapin, Hurlbush, Smith and others contributed quite a liberally and the fund was swelled to goodly proportions by the following night. There is no reason why Jerome should not support a grounds club and the prospect of it is fairly promising. The next meeting will be held at the office of the

Twin Falls, Will Play Rupert on New Grounds on Sunday.

The Rupert baseball team which played a game on the side of the Twin Falls club last year, will open the season here on Sunday afternoon on the new ball grounds. Work is being done on the grounds and it will be scarcely be possible to have the roof on in time for the game, the seats will be in place. The grounds are working up and the stadium is already in good condition.

Rupert has always presented a stout front on the ball field and will undoubtedly send down a strong team. The time they have been devoting to the time they could spare to practice and the game should be spirited. In any event the boys are deserving of liberal patronage they have done their best to provide Twin Falls with attractive grounds and a line of which the city may well be proud. It has been a hard and arduous task and the boys should receive the support which they merit.

"PLAY BALL," SAYS THE UMPIRE

Twin Falls, Will Play Rupert on New Grounds on Sunday.

The Rupert baseball team which played a game on the side of the Twin Falls club last year, will open the season here on Sunday afternoon on the new ball grounds. Work is being done on the grounds and it will be scarcely be possible to have the roof on in time for the game, the seats will be in place. The grounds are working up and the stadium is already in good condition.

Rupert has always presented a stout front on the ball field and will undoubtedly send down a strong team. The time they have been devoting to the time they could spare to practice and the game should be spirited. In any event the boys are deserving of liberal patronage they have done their best to provide Twin Falls with attractive grounds and a line of which the city may well be proud. It has been a hard and arduous task and the boys should receive the support which they merit.

"PLAY BALL," SAYS THE UMPIRE

Twin Falls, Will Play Rupert on New Grounds on Sunday.

The Rupert baseball team which played a game on the side of the Twin Falls club last year, will open the season here on Sunday afternoon on the new ball grounds. Work is being done on the grounds and it will be scarcely be possible to have the roof on in time for the game, the seats will be in place. The grounds are working up and the stadium is already in good condition.

Rupert has always presented a stout front on the ball field and will undoubtedly send down a strong team. The time they have been devoting to the time they could spare to practice and the game should be spirited. In any event the boys are deserving of liberal patronage they have done their best to provide Twin Falls with attractive grounds and a line of which the city may well be proud. It has been a hard and arduous task and the boys should receive the support which they merit.

"PLAY BALL," SAYS THE UMPIRE

Twin Falls, Will Play Rupert on New Grounds on Sunday.

The Rupert baseball team which played a game on the side of the Twin Falls club last year, will open the season here on Sunday afternoon on the new ball grounds. Work is being done on the grounds and it will be scarcely be possible to have the roof on in time for the game, the seats will be in place. The grounds are working up and the stadium is already in good condition.

Rupert has always presented a stout front on the ball field and will undoubtedly send down a strong team. The time they have been devoting to the time they could spare to practice and the game should be spirited. In any event the boys are deserving of liberal patronage they have done their best to provide Twin Falls with attractive grounds and a line of which the city may well be proud. It has been a hard and arduous task and the boys should receive the support which they merit.

"PLAY BALL," SAYS THE UMPIRE

Twin Falls, Will Play Rupert on New Grounds on Sunday.

BUHL BACHELORS BECOME NERVOUS

RATTLED BY RECENT DESERTIONS FORM CLUB.

Three Marriages in One Week Causes a Waver in the Ranks—Frank Mayward Tries to Shoot a Corn Out of His Toe.

BUHL, Ida., May 6.—A young clerk arrived at the home of Mr. and Mrs. O. S. Foor Friday night. The young man is already running the Buhl Trading company's business. Mother and child are doing well and Pa Peck is expected to recover, but there is little hope for Gracie Peck. He will not speak to common people any more.

Judge Barlow is setting out an orchard on his ranch adjoining the townsite.

N. G. Scott has taken up his residence on his ranch on Ferguson flats for the purpose of proving up.

Amos Howard sold his 40 acres, a quarter of a mile north of town, for \$2200, the early part of this week.

Thomas MacCauley was a Twin Falls business visitor Monday.

Miss Agnes Carroll and F. S. Hayward, assistant cashier of the City Bank, were married in Twin Falls Saturday, and are spending their honeymoon at the Riverside ranch on the Snake river. Mr. Hayward had the misfortune to accidentally shoot himself Monday while handling a revolver, the ball striking him on the knee and glancing downward the leg making a painful but not serious wound. He is still at Judge Uhlraus's on the river but is expected home in a day or two.

W. T. Snodgrass is moving his dwelling house and main street on his lot just that side of the street.

J. F. Frith is up from Thousand Springs with his stallion, which will be at J. H. Schenckel's stables for the season.

Don McKay has severed his connection with the Hotel Buhl and is visiting at Blue Lakes for a week. Mr. McKay has a 60 wheel car in his lot to improve during the summer, and will remain a resident of the west end. Glad we are not going to lose you.

Miss Anna Miller of Cephas, Ida., was in town Thursday on a shopping tour.

A. W. Bishop was in from his ranch on Ferguson flats Thursday on business.

Miss Alberta Hovey came in from the ranch Sunday and did some shopping.

Mr. Scott Dolk arrived Friday from Boise to look after his interests here. Mr. Dolk owns considerable property in and around Buhl, but has been in poor health lately and has not been able to go ahead with the improvements he started last fall.

Geo. Daily and Levi Daily of Waldlow, Oregon, were among the settlers on this end of the tract Thursday.

G. W. Barnes of Boise, Idaho, was a Buhl business visitor Friday.

John D. Davis, one of the Salt Lake City, was looking over this end of the Buhl property with a view to making an investment.

N. J. Chellie of Orleans, Neb., was a Buhl business visitor last week and took a look over the country with a view to making an investment.

Dr. J. McHenry of Payson, Utah, was a visitor on this end of the tract Saturday. Dr. McHenry owns a ranch near Payson and his trip to Buhl was for the purpose of making arrangements for having it improved.

Mrs. Clara Smith of Twin Falls arrived in Buhl Sunday evening and will spend the week on the tract for the purpose of making final proof.

Judge F. E. Chamberlain, accompanied his sister, Mrs. Smith, to Buhl Sunday. They drove up from Twin Falls. The judge superintended the building of his sister's residence on her ranch and returned to Twin Falls Friday.

Miss Paul S. A. Bickel and Miss Edith Clark visited in Buhl Monday. B. S. Brokke of St. Paul, Minn., registered at Hotel Buhl Wednesday.

C. W. Arthur was up from Abbe Tuesday on business.

John D. Davis was in from his ranch on Ferguson flats Monday on business.

Miss Ollie J. Slater of Boise registered at Hotel Buhl Tuesday.

L. F. Wislman came in from the ranch Monday on business.

William North of Salt Lake City, Utah, was a Buhl business visitor Monday.

John D. Davis was in from his ranch Tuesday for supplies.

L. L. Liffey was up from Cephas Monday on a visit with some of the town people.

Mrs. E. M. Sweeley came up from Twin Falls Monday and went out to live on their ranch for the purpose of making final proof.

R

Notice of Democratic County Convention.
By virtue of the authority vested in the Democratic County Central Committee of Twin Falls county, state of Idaho, notice is hereby given that the Democratic County Convention of said county is hereby called to convene in the city of Twin Falls, in said county on Saturday, the 23rd day of May, 1908, at the hour of 2 o'clock in the afternoon, for the purpose of selecting nine delegates and nine alternate delegates to the state Democratic convention to be held in the city of Twin Falls, state of Idaho, June 3rd, 1908, and to the state Democratic convention to be held at the city of Wallace, state of Idaho, August 4th, 1908.

The various precincts of the county are entitled to delegates to said county convention as follows:
North Twin Falls 10, South Twin Falls 10, Filer 4, Hansen 4, Murtaugh 2, Rock Creek 4, Butte 2, Buhl 7, Kimberly 4, Maros 3, Miller 2, Roosevelt 2.

The primaries for the election of delegates to said county convention will be held at the regular voting place in each precinct on the 21st day of May, 1908, polls to be open at 2 o'clock p. m. and close at 7 o'clock p. m. of said day.

By order of the Democratic County Central Committee of Twin Falls county, state of Idaho, lawfully assembled April 15, 1908:

P. H. SMITH, Chairman.
W. A. BABCOCK, Secretary.

Notice for Publication—Final Proof.
I, Gottfred Sommer, of Filer, Idaho, who made entry No. 283, under the provisions of an act of the legislature of the state of Idaho, commonly known as the "Caray act," approved March 2nd, 1899, which embraces the NW 1/4 of NE 1/4 of NW 1/4 of section 16, township 10 S., range 16 E., do hereby give notice of my intention to make final proof to establish my claim to the land above described, and that I expect to prove that I have resided on, reclaimed and cultivated said land as required by law, before E. B. Williams, at Twin Falls, Idaho, on the 23rd day of May, 1908, by two of the following witnesses: Adam Shiffman, E. H. Bettie, H. M. Harding and Clifford Roscoe, all of Filer, Idaho.

GOTTTFRED SOMMER, Entryman.

None but experienced help at Blisbee's to finish up your work.

FOR SALE—40 bushels of Dicklow wheat. Inquire St. John Skinner.

Girl wanted for general housework. Apply Mrs. Holahan, 9th and 7th Ave., Twin Falls.

Single comb Rhode Island Red eggs for hatching. W. L. Snyder, one mile east on phone line.

Our specialty, taking pictures of babies, at Blisbee's.

F. V. R. cabbage plants for sale. Fairview ranch, one-half mile NE of city.

Man and wife wanted to take charge of farm at once. Inquire St. John Skinner, at Abstract office over First National bank.

Strawberries—Raspberries. For strawberries and raspberry plants see A. P. Smith, Sixth avenue and Blue Lakes boulevard, Twin Falls, Idaho.

All photo work guaranteed and orders filled promptly at Blisbee's.

\$4000 to loan on farm security, 10 years time. Missouri Land Co., room 5, Commercial and Savings bank, Twin Falls, Idaho.

For successful pictures of your baby go to Blisbee's.

Mining Location Blanks at The News office.

Amateur work a specialty at Blisbee's.

Desert Land—Final Proof.
United States Land Office, Hattley, Idaho.
April 29, 1908.
Notice is hereby given that John D. Sawyers, of Rock Creek, Idaho, has filed notice of intention to make final proof on his desert-land claim No. 1229, for the NE 1/4 of NE 1/4 of section 15, SW 1/4 of SW 1/4 of section 17, NW 1/4 of NW 1/4 of section 14, township 12 S., range 17 E. B. M., before John F. Hansen, U. S. Commissioner at Rock Creek, Idaho, on the 2nd day of June, 1908.

He names the following witnesses to prove the complete irrigation and reclamation of said land: Henry Jones, Arthur B. Norton, William O. Trimmer and Thomas Gray, all of Rock Creek, Idaho.

A. I. McMAHON, Register.

Apr. 24 May 1-7-15-22.

Notice for Publication—Final Proof.
I, Henry Hansen, of Rock Creek, Idaho, who made entry No. 1896, under the provisions of an act of the legislature of the state of Idaho, commonly known as the "Caray act," approved March 2nd, 1899, which embraces NW 1/4 of SW 1/4 of section 24, township 10 S., range 16 E., do hereby give notice of my intention to make final proof to establish my claim to the land above described, and that I expect to prove that I have resided on, reclaimed and cultivated said land as required by law, before E. B. Williams, at Twin Falls, Idaho, on the 23rd day of May, 1908, by two of the following witnesses: C. D. Duffie, J. A. Poole and Walter Broese of Rock Creek and Robert Broese of Twin Falls, Idaho.

HENRY HANSEN, Entryman.

Notice for Publication—Final Proof.
I, At Marshall of Twin Falls, Idaho, assignee of A. F. and A. W. DuBois, Van Alderend, who made entry No. 1050, under the provisions of an act of the legislature of the state of Idaho, commonly known as the "Caray act," approved March 2nd, 1899, which embraces the SW 1/4 of NW 1/4 of section 14, township 11 S., range 17 E. B. M., do hereby give notice of my intention to make final proof to establish my claim to the land above described, and that I expect to prove that I have resided on, reclaimed and cultivated said land as required by law, before E. B. Williams at Twin Falls, Idaho, on the 23rd day of May, 1908, by two of the following witnesses: C. Kline, W. H. Cullington, W. W. Moers and W. A. Logan, all of Twin Falls, Idaho.

AT MARSHALL, Entryman.

Notice for publication.
Department of the Interior, Land Office at Hattley, Idaho.
April 29th, 1908.

Notice is hereby given that Frank A. French of Hansen, Twin Falls Co., Idaho, has filed notice of his intention to make final commutation proof in support of his claim, viz: Homestead entry No. 6144 made Feb. 21, 1907, for the NW 1/4 of NE 1/4 of SW 1/4 of section 21, township 10 S., range 16 E. B. M., and that said proof will be made before John F. Hansen, U. S. Commissioner, at Rock Creek, Twin Falls county, Idaho, on June 23rd, 1908.

He names the following witnesses to prove his continuous residence upon and cultivation of the land, viz: James L. Barnes, Bruce E. Rose, Lloyd Towne and Robert E. Roberts, all of Hansen, Idaho.

A. I. McMAHON, Register.

May 1-8-15-22-29.

Five-foot steel grubber in first-class condition. Inquire of Frank Bower, Rock Creek, Idaho.

Hotel for Sale.
Is netting the owner \$150.00 per month. The only place in town. If interested come and see me.

A. G. LAMMERS, Filer, Idaho.

Notice of Publication.
Notice is hereby given that at 10 a. m., on the 4th day of May, 1908, at Rock Creek, county of Twin Falls, state of Idaho, before John F. Hansen, U. S. Commissioner, proof will be submitted of the completion of works for the diversion of 3.2 cubic feet per second of the waters of west fork of the Rock creek in accordance with the terms and conditions of a certain permit heretofore issued by the state engineer of the state of Idaho.

The name of the person holding said permit is James B. Rice.

The postoffice address of each person is Rock Creek, county of Twin Falls, state of Idaho.

1. The number of such permit is 2160, and the date set for the completion of such work is April 5, 1908.

2. Said works of diversion will be fully completed on the date set for such completion, and the amount of water which said works are capable of conducting to the place of intended use in accordance with the plan accompanying the application for such permit is 3.2 cubic feet per second.

3. The amount of lands for which said water is available is 100 acres, particularly described as follows: SW 1/4 of SW 1/4 of sec. 25, E 1/2 of SE 1/4 of NW 1/4 of sec. 22, township 11 S., range 18 E. B. M.

JAS STEPHENSON, JR., State Engineer.

Apr. 10-17-24 May 1.

Notice to Creditors.
Estate of Leander M. Lucy, deceased.

Notice is hereby given by the undersigned administrator of the estate of Leander M. Lucy deceased, to the creditors of and all persons having claims against the said deceased, to exhibit them with the necessary vouchers, within 10 months after the first publication of this notice, to the said administrator, county of Twin Falls, state of Idaho.

Dated April 27th, 1908.

FRANCES M. LUCY, Administratrix of the estate of Leander M. Lucy, deceased.

JOHN E. DAVIES, Attorney for administratrix.

May 1-8-15-22-29.

Notice for Publication—Final Proof.
I, William R. Bell, of Filer, Idaho, assignee of James B. Miller, who made entry No. 942, under the provisions of an act of the legislature of the state of Idaho, commonly known as the "Caray act," approved March 2nd, 1899, which embraces E 1/2 of NW 1/4 of section 14, township 10 S., range 16 E. B. M., do hereby give notice of my intention to make final proof to establish my claim to the land above described, and that I expect to prove that I have resided on, reclaimed and cultivated said land as required by law, before E. B. Williams, at Twin Falls, Idaho, on the 23rd day of May, 1908, by two of the following witnesses: James T. Bell, Henrietta Bell and J. D. Fisher, all of Filer, Idaho.

WILLIAM R. BELL, Entryman.

Notice for Publication—Final Proof.
I, Edwin M. Crockett, of Rock Creek, Idaho, who made entry No. 1894, under the provisions of an act of the legislature of the state of Idaho, commonly known as the "Caray act," approved March 2nd, 1899, which embraces SW 1/4 of NE 1/4 of section 30, township 11 S., range 18 E. B. M., do hereby give notice of my intention to make final proof to establish my claim to the land above described, and that I expect to prove that I have resided on, reclaimed and cultivated said land as required by law, before E. B. Williams, representative of the state land board, at Twin Falls, on the 9th day of May, 1908, by two of the following witnesses: M. D. Crockett, James Dunks and John Barnes, all of Rock Creek, Idaho.

EDWIN M. CROCKETT, Entryman.

Notice of meeting of Republican State Conventions.
Pursuant to the authority of the Republican state central committee, and in accordance with their action, notice is hereby given that a Republican state convention will convene in the city of Wallace, state of Idaho, on Tuesday, the 12th day of May, 1908, at 11 o'clock a. m. of said day for the purpose of electing delegates to the Republican national convention to be held in the city of Chicago, state of Illinois, on the 16th day of June, 1908.

And, pursuant to the authority and by the direction of the Republican state central committee, a Republican state nominating convention will convene at the city of Boise, state of Idaho, on Tuesday, the first day of September, 1908, at 11 o'clock a. m. at which state convention a Republican platform or principles will be announced, a new state central committee will be elected, and candidates will be nominated for justice of the Supreme court, one member of congress, and state officers to be voted for at the general election to be held on Tuesday, November 3, A. D. 1908.

The various counties of the state are entitled to delegate representation in each state convention as follows:

Ada 24
Boise 24
Bonner 6
Bonneville 6
Canyon 18
Cassia 6
Custer 6
Elmore 6
Fremont 6
Idaho 13
Kootenai 13
Latah 13
Lemhi 6
Lincoln 6
Lost River 6
Nevada 21
Owyhee 4
Oneida 22
Shoshone 16
Teton 6
Washington 9

Total 303

A resolution was passed by the state central committee, properly assembled, to the effect that the county central committees be recognized as having the right to hold their county conventions together if they so desired and say it, and authority is hereby given to the county central committees to take such action in the premises as they see proper, and they are hereby requested to perfect all arrangements for primary and county conventions for the selection of delegates to said state conventions.

The state central committee is hereby called to meet at Wallace, Idaho, on Tuesday, the 12th day of May, 1908, at 10 o'clock a. m. for the purpose of transacting such business as may properly be brought before it.

JAMES H. RADY, Chairman.

Addison T. Smith, Secretary.

Notice for Publication—Final Proof.
I, Clara P. Smith, of Twin Falls, Idaho, assignee of Robert W. Steele, who made entry No. 1961, under the provisions of an act of the legislature of the state of Idaho, commonly known as the "Caray act," approved March 2nd, 1899, which embraces the NW 1/4 of SW 1/4 of section 25, township 10 S., range 14 E. B. M., do hereby give notice of my intention to make final proof to establish my claim to the land above described, and that I expect to prove that I have resided on, reclaimed and cultivated said lands as required by law, before E. B. Williams at Twin Falls, Idaho, on the 23rd day of May, 1908, by two of the following witnesses: H. Howard and J. M. Shank of Buhl, Idaho and F. E. Chamberlain of Twin Falls, Idaho.

CLARA P. SMITH, Entryman.

Alias Summons.
In the District court of the Fourth Judicial district, state of Idaho, and for Twin Falls county.
Nollie Ferner, plaintiff, vs. G. D. Alken as sheriff of said county and McCornick & Co., a co-partnership, defendants.
The state of Idaho assigns greetings to George D. Alken, as sheriff of Twin Falls county, Idaho, and McCornick & Co., a co-partnership, defendants.

You are hereby summoned and required to appear in an action brought against you by said plaintiff in the District court, and to answer the complaint of the above-named plaintiff filed therein, within 20 days (exclusive of the day of service) after the service on you of this summons, if served within this judicial district, or if served elsewhere within 40 days.

The said action is brought to recover damages in the sum of \$3000 and recovery for wrongful attachment of property in the sum of \$600.00 as will more fully appear in plaintiff's complaint as above required, the said complaint is hereto attached, served herewith and made a part of this summons.

And you are hereby notified that if you fail to appear and answer said complaint as above required, the said plaintiff will take judgment against you for the sums named in the complaint, to-wit: \$3000 damages, \$600 and costs of this action.

Attest my hand and the seal of the District court of the Fourth Judicial district, state of Idaho, in and for Twin Falls county, this 8th day of April, 1908.

H. T. WILSON, Clerk.

T. RAILLEY LEE, Attorney for plaintiff, residing at Buhl, Idaho.

Apr. 24 May 1-8-15-22.

Notice for Publication—Final Proof.
I, Milton H. Baylor, of Twin Falls, Idaho, assignee of Frances M. Palmer, who made entry No. 2104, under the provisions of an act of the legislature of the state of Idaho, commonly known as the "Caray act," approved March 2nd, 1899, which embraces the E 1/2 of SW 1/4 of section 28, township 10 S., range 16 E. B. M., do hereby give notice of my intention to make final proof to establish my claim to the land above described, and that I expect to prove that I have resided on, reclaimed and cultivated said land as required by law, before E. B. Williams, at Twin Falls, Idaho, on the 23rd day of May, 1908, by two of the following witnesses: F. A. Wilson, Ivan Lincoln, A. L. Baustre and William Lincoln, all of Filer, Idaho.

MILTON H. BAYLOR, Entryman.

Notice for Publication—Final Proof.
I, Amos H. Sonner, of Filer, Idaho, assignee of John Balch, who was assigned of Geo. G. Dodd, who was assignee of James J. Redmond, who made entry No. 1214, under the provisions of an act of the legislature of the state of Idaho, commonly known as the "Caray act," approved March 2nd, 1899, which embraces NW 1/4 of section 25, township 10 S., range 16 E. B. M., do hereby give notice of my intention to make final proof to establish my claim to the land above described, and that I expect to prove that I have resided on, reclaimed and cultivated said land as required by law, before E. B. Williams at Twin Falls, Idaho, on the 23rd day of May, 1908, by two of the following witnesses: James A. Martin, John E. King and Oscar Melby of Filer, Idaho.

AMOS H. SONNER, Entryman.

Notice to Contractors.
The board of trustees of the First Presbyterian church of Twin Falls, Idaho, will receive bids for the erection of the church building above the foundation—until Saturday evening, May 9th, 1908, and specifications can be seen at Hill & Taylor's office.

C. M. HILL, Chairman.

Have your kodak work done at Blisbee's.

Notice for Publication—Final Proof.
I, Samuel D. Clinton, of Twin Falls, Idaho, assignee of Charles H. Mull, who made entry No. 1891, under the provisions of an act of the legislature of the state of Idaho, commonly known as the "Caray act," approved March 2nd, 1899, which embraces lot 9 and SW 1/4 of NE 1/4 of section 23, township 10 S., range 19 E. B. M., do hereby give notice of my intention to make final proof to establish my claim to the land above described, and that I expect to prove that I have resided on, reclaimed and cultivated said land as required by law, before E. B. Williams at Twin Falls, Idaho, on the 23rd day of May, 1908, by two of the following witnesses: J. Barnes, of Hansen, E. V. Bern, Charles H. Mull and Harry Ball of Twin Falls, Idaho.

SAMUEL D. CLINTON, Entryman.

Notice for Publication—Final Proof.
I, Frank A. Eveleth, of Buhl, Idaho, who made entry No. 1943, under the provisions of an act of the legislature of the state of Idaho, commonly known as the "Caray act," approved March 2nd, 1899, which embraces NE 1/4 of SE 1/4 of section 24, township 9 S., range 14 E. B. M., do hereby give notice of my intention to make final proof to establish my claim to the land above described, and that I expect to prove that I have resided on, reclaimed and cultivated said land as required by law, before E. B. Williams, at Buhl, Idaho, on the 12th day of May, 1908, by two of the following witnesses: Geo. L. Eveleth, Fred N. Hansen, E. O. Tolson and D. E. Alben, all of Buhl, Idaho.

FRANK A. EVELETH, Entryman.

Notice for Publication—Final Proof.
I, Benjamin F. McPherson, of Filer, Idaho, who made entry No. 925, under the provisions of an act of the legislature of the state of Idaho, commonly known as the "Caray act," approved March 2nd, 1899, which embraces the SW 1/4 of NW 1/4 of section 33, township 9 S., range 16 E. B. M., do hereby give notice of my intention to make final proof to establish my claim to the land above described, and that I expect to prove that I have resided on, reclaimed and cultivated said land as required by law, before E. B. Williams at Twin Falls, Idaho, on the 8th day of May, 1908, by two of the following witnesses: Jay Womack, Fred Stridley, A. W. Russell and Clyde C. Anderson, all of Filer, Idaho.

BENJAMIN F. MCPHERSON, Entryman.

Notice for Publication—Final Proof.
I, Frances F. Wylie, who made entry No. 1074, under the provisions of an act of the legislature of the state of Idaho, commonly known as the "Caray act," approved March 2nd, 1899, which embraces E 1/2 of SW 1/4 of section 2, township 11 S., range 16 E. B. M., do hereby give notice of my intention to make final proof to establish my claim to the land above described, and that I expect to prove that I have resided on, reclaimed and cultivated said land as required by law, before E. B. Williams at Twin Falls, Idaho, on the 23rd day of May, 1908, by two of the following witnesses: H. H. Hinton, J. F. Denny, Clarence Padgett and Ben Diller, all of Twin Falls, Idaho.

FRANCES F. WYLIE, Entryman.

Notice to Owners of Dogs.
Notice is hereby given that the license provided by ordinance of city of Twin Falls to be paid by any person who is the owner of or keeps a dog should be paid to the city clerk, person appointed to collect the same at once.

All dogs found within the city limits without license tag will be impounded and disposed of at once, by distance.

L. E. PROTHRO, City Marshal.

FOR SALE—400 lbs. of A No. 1 home grown red clover seed. A. O. Fisher at Bedford's drug store.

FOR SALE—Seed oats, Whitelake and Big Four. Inquire to Mr. south of Kimberly, J. N. McMaster.

CHILDREN'S OXFORD SPECIALS

Warm weather shoes for children are the order of the day and we are this week making a marked reduction for our customers' benefit. We want you to be ready for the warm weather.

25 Cents to 50 Cents Per Pair Reduction

Broken sizes in Children's and Misses' White Canvas at cost. Don't miss this great saving in shoes. You can also make a

GREAT SAVING in Ladies' and Men's Shoes this week.

Don't forget the big \$10 SILK SUIT SALE Saturday and Monday

BOOTH LIVERY GOODS CO.

(Continued on Page 6.)

TWIN FALLS NEWS

George B. Fraser, Editor.

Published every Friday by
THE NEWS PUBLISHING COMPANY
TWIN FALLS, IDAHO.

Subscription Rates.
One Year, in Advance, \$2.00
Six Months, in Advance, \$1.00

Available information regarding the city and country promptly furnished. Address communications to The News Publishing Company, Twin Falls, Idaho.

Entered as second-class matter, December 2, 1904, at the post office at Twin Falls, Idaho, under Act of Congress of March 3, 1879.

While the action of the council in re-naming the streets may not meet with the approval of the majority of the citizens of Twin Falls, the sincerity and good faith of the aldermen is above reproach. If the people desired to have the streets named, they should have met with the council and expressed their views. It matters not to the News whether the streets are named after the fish of the sea, the beasts of the field, the birds of the air or the stars of the sky. This paper merely voiced the sentiment of the people who have made persistent complaint for three years against the existing nomenclature. Last week a Twin Falls lady advertised second hand furniture for sale. She did not know what street she lived on, and even if she had it would have been necessary for a stranger to hire an engineer in order to find the house. The lady did not receive any calls for her furniture, as it happened, but her neighbors were kept busy answering inquiries. This sort of thing happens every day. M. M. Murtough, who stands sponsor for the present system, declared in the council meeting on Wednesday night and reiterated that the trouble was due to the ignorance of the people of Twin Falls. Mr. Murtough's judgment on engineering problems is beyond question, but the citizens of Twin Falls will hesitate to accept his dictum regarding their mentality. However, the question has been settled by the council and nobody is going to throw rocks at the aldermen for acting as they did. The new system will undoubtedly be an improvement and if the people are not satisfied with it, they can have it changed.

MATERIAL FOR WORK ON SALMON

Big Orders Have Been Placed by the Company.

The Salmon river company has contracted with C. R. Shaw of Boise for 65,000 barrels of cement for the construction of the dam. To transport this cement to Twin Falls will require 16 trains of 20 cars each. The company has ordered a traction engine of 110-horsepower and eight wagons with a capacity of 12 tons each to haul the cement from Twin Falls to the dam site. The engine will have a speed of three miles an hour and will pull out four wagons while the other four are being loaded. It will make the round trip in two days.

The company has also arranged for the erection of a cement warehouse at the dam, also a house for the officers and a mess house with 70 seats. The capacity of 200. It will sit well above the high water line and erect storage tanks. A commissary will likewise be put up at once. An office building has been provided for and when the quarters at the dam are completed they will make a tidy village.

ATTENTION!—Civil War Veterans. You are requested to meet A. M. Rowe, department commander, Grand Army of the Republic, department of Idaho, at Twin Falls, in the office of Commander James W. Shields, First National bank building, May 11, next, at 2 p. m. The meeting is called for the purpose of organizing a G. A. R. post. It is greatly desired to complete the organization before Decoration day. Ten comrades are required to organize and there are 20 odd on the tract. Let all come!

R. H. BARNES, JAMES W. SHIELDS, Committee.

Notice for Publication—Final Proof. I, Everett M. Sweeley, of Twin Falls, Idaho, who made entry No. 2025, under the provisions of an act of the legislature of the state of Idaho, commonly known as the "Carey act," approved March 2nd, 1899, which embraces the SE 1/4 of SE 1/4 of section 13 and the NW 1/4 of NE 1/4 and SW 1/4 of NE 1/4 of section 24, township 13 E. B. M., do hereby give notice of my intention to make final proof to establish my claim to the land above described, and that I expect to prove that I have resided on and reclaimed and cultivated said land as required by law, before E. B. Williams, at Twin Falls, Idaho, on the 8th day of June, 1908, by two of the following witnesses: Harry B. Lewis, Alva A. Sloucomb, Albert N. Ring and Marlin J. Sweeley, all of Twin Falls, Idaho.

EVERETT M. SWEeley, Entryman.

Eggs for Setting. Silver laced Wyandottes, \$1.50 for 15. Inquire Booth's Dry Goods Co., Twin Falls.

Notice for Publication—Final Proof. I, Samuel D. Clinton, of Twin Falls, Idaho, assignee of Charles H. Mull, who made entry No. 1891, under the provisions of an act of the legislature of the state of Idaho, commonly known as the "Carey act," approved March 2nd, 1899, which embraces the SE 1/4 of NE 1/4 of section 10 and SW 1/4 of NE 1/4 of section 23, township 10 S., range 19 E. B. M., do hereby give notice of my intention to make final proof to establish my claim to the land above described, and that I expect to prove that I have resided on and reclaimed and cultivated said land as required by law, before E. B. Williams at Twin Falls, Idaho, on the 5th day of May, 1908, by two of the following witnesses: J. Barnes, of Hansen, E. V. Berg, Charles H. Mull and Harry Ball of Twin Falls, Idaho.

SAMUEL D. CLINTON, Entryman.

Deferred until May 15th, 1908.

Peking ducks, Toulouse geese, all the leading laying strains—Hens, eggs and fowls for sale. Mrs. Olla Systar, Clear Lake, Idaho, five miles north of Buhl.

Notice for Publication—Final Proof. I, Marlin J. Sweeley, of Twin Falls, Idaho, who made entry No. 2025, under the provisions of an act of the legislature of the state of Idaho, commonly known as the "Carey act," approved March 2nd, 1899, which embraces the SE 1/4 of NE 1/4, NW 1/4 of SW 1/4 and the W 1/4 of SE 1/4 of section 10, township 9 S., range 13 E. B. M., do hereby give notice of my intention to make final proof to establish my claim to the land above described, and that I expect to prove that I have resided on and reclaimed and cultivated said land as required by law, before E. B. Williams, at Twin Falls, Idaho, on the 8th day of June, 1908, by two of the following witnesses: Everett M. Sweeley, Harry B. Lewis, Alva A. Sloucomb of Twin Falls and Albert N. Ring of Buhl, Idaho.

MARLIN J. SWEeley, Entryman.

Bungalow plans furnished for \$15 and upwards. L. P. Clifton, architect. Office with Garlock & Co., Twin Falls.



IF YOU WANT STYLISH SPRING SUITS—WE HAVE THEM.

They're not only stylish, they're quality productions. To prove that, we need only to point to the label on each garment.

THE PALMER GARMENT

Don't forget that we are carrying the swellest line of Millinery in Southern Idaho, at prices that can't be duplicated. The Celebrated W. B. Corsets in pleasing styles.

LADIES EMPORIUM

PIKE BUILDING, MAIN ST., TWIN FALLS, IDAHO.

Its Economy!

TO HAVE YOUR FAMILY WASHING DONE AT THE

Falls Steam Laundry

SAVES

Trouble and backaches. Soap and fuel. The fumes and mists of wash day. You will feel brighter and have a pleasanter smile for husband. Called for and delivered sweet and clean.

PHONE 65.

ANHEUSER BUSCH and BUDWEISER

ON DRAUGHT

ENJOY A ST. REGIS HIGHBALL AT THE ST. REGIS BAR.

MOORE & WAMSLEY

Proprietors TWIN FALLS, IDAHO

THE NEW JEWELER

Having purchased the entire stock of M. Musgrave, Jeweler, I will endeavor to give the people the best to be had in my line. Fine Engraving, Watchmaking and Repairing. Call and convince yourself.

C. D. ANDERSON, 913 MAIN STREET, TWIN FALLS, IDA.

LOOK! LOOK!!

RESIDENCE LOTS CLEARED, CESSPOOLS AND CELLARS DUG. ODD JOBS OF ALL KIND PROMPTLY ATTENDED TO.

ADDRESS

J. R. JOHNSON

GENERAL DELIVERY, TWIN FALLS, IDAHO.

PROFESSIONAL CARDS

EDWARD E. GARRETT,
Land Attorney.

For nine years receiver U. S. Land Office, Boise. Practiced in all matters relating to public lands.
307 Boise City National Bank Bldg. BOISE, : : : : IDAHO.

D. W. BRUNK
LICENSED AUCTIONEER

Fifteen Years' Experience. Satisfaction Guaranteed.

Office upstairs in Fox Building, Main Street, Twin Falls.

H. A. MUNYON
Licensed Auctioneer.

Satisfaction guaranteed or no charge. Fifteen years experience.

FILED : : : : IDAHO.

L. P. Clifton, Architect.

Plans, specifications and estimates furnished on public buildings, bungalows, etc.

Office with Garlock & Co., Twin Falls, : : : : IDAHO.

Contractors & Builders.

BARCOCK, WINN & PENNOCK.
Estimates Furnished.

Box 231, Twin Falls, Idaho.

ATWOOD FELT COMPANY.
Building Contractors.

Office and Shop corner Sheehane Ave. and Fourteenth St.

PHONE : : : : 178.

SECRET SOCIETIES

TWIN FALLS LODGE NO. 45, A. F. & A. M.

Regular meetings held the first Monday of each month. Sojourning brethren cordially welcome.

E. A. BAKER, CHAS. H. MULL, Secy.

M. W. A., CAMP NO. 10890.

Meets 2nd and 4th Wednesdays of each month.

J. M. ROGERS, Consul. D. W. BRUNK, Clerk.

Phone 123. Idaho Dept. Store Bldg.

TWIN FALLS CHAPTER, O. E. S.

Meets second and fourth Mondays in every month in K. of P. hall.

Matron, MRS. J. B. ELLIS.

TWIN FALLS LODGE NO. 23, I. O. O. F., instituted 1905.

Meets every Thursday evening at 7:30. Visiting brothers always welcome.

C. B. CARTWRIGHT, H. A. CRYDER, Noble Grand, Secretary.

NOTED CAPITALISTS COMING

Will Arrive in Twin Falls Saturday, May 23.

Three private cars, bearing bankers and heads of bond houses from Chicago, St. Paul, Minneapolis, Omaha, Cleveland, St. Joseph, St. Louis, Kansas City and elsewhere, will leave Chicago on the evening of May 19 bound for Twin Falls. With the party will be J. G. White, head of the contracting firm of J. G. White & Co., New York, the largest in the west. It is also likely that Tom R. Johnson, the famous mayor of Cleveland, and David R. Francis of St. Louis will be among the visitors.

The visitors are coming to look over irrigation investments and to make personal inspection of the Twin Falls and Salmon tracts. They will spend a week in southern Idaho. It is possible that Leslie M. Shaw, former secretary of the treasury, will join the party in Chicago.

President C. B. Hurst of the Twin Falls Investment Co., while on his recent trip through the east, called upon the gentlemen who are coming and invited them to make the journey to Idaho. He succeeded in inducing them to such an extent that they agreed to devote a week to this section of the state. Their coming will be awaited with keen interest as it means a great deal to Twin Falls.

Sealed Proposals. Sealed proposals will be received at the office of the clerk of the board of trustees of Kimberly School District No. 6, Kimberly, Idaho, up to and until the hour of 1 o'clock May 23, 1908, for furnishing all material and doing all labor necessary to construct an eight-room, graded school building, in accordance with plans and specifications prepared by J. E. Tourtellot & Co., architects, Boise, Idaho.

A certified check made payable to Martin Sullivan, clerk, in the sum of one hundred (\$100.00) dollars shall accompany each general proposal as a guarantee that successful bidder will enter into a contract with the above board and will furnish a satisfactory bond for the performance of same.

The right is reserved to reject any or all bids submitted. Plans may be seen at the home of the clerk and at the office of the architects.

(Signed) MARTIN SULLIVAN, Clerk.

May 14-22

The Don Bryan Realty Co. will loan you out Salmon river land and guarantee satisfaction for 50 cents per acre.

Bungalow plans furnished for \$15 and upwards. L. P. Clifton, architect. Office with Garlock & Co., Twin Falls.

For information about Twin Falls, write the Don Bryan Realty Co.

PROFESSIONAL CARDS

DR. H. W. CLOUCHEK
Physician and Surgeon

Two Years Resident Physician at University of Michigan, Ann Arbor, Michigan.

TWIN FALLS CITY, IDAHO

DR. J. R. MORGAN
Physician and Surgeon

Graduate of Northwestern University Medical School of Chicago.

Office in Smith-Bradley Bldg. opp. Hotel Perrine.

H. Schmalhausen.
Physician & Surgeon.

Oculist & Aurist.

Office, ground floor, next door to Palace Meat Market.

DR. J. D. HUME
Osteopath

Office Pacific Hotel

Phone 105.

Chronic diseases a specialty.

Office hours 9 A. M. to 4 P. M.

DR. D. BROWN LEWERS
DENTIST

Bradley & Smith Block, Opposite Hotel Perrine.

Graduate of Maryland.

Licentiate of Pennsylvania.

Phone No. 109

DR. H. T. BILLINGTON
Osteopath

Consultation Free.

Office in Stothard Bldg. Phone 69.

TWIN FALLS, IDAHO.

P. H. HALL
Contractor and Builder

Estimates cheerfully furnished.

Twin Falls, Idaho.

SWEeley & SWEeley
Attorneys at Law.

Practice in all Courts.

TWIN FALLS : : : : IDAHO

S. H. HAYS
Attorney at Law

321 Main street BOISE, IDAHO

HAWLEY PUCKETT & HAWLEY
Rooms 1-8 Odd Fellows Bldg.

BOISE : : : : IDAHO

Attorneys at Law.

Practice in all state and United States courts.

James H. Hawley, W. H. Puckett and Jess Hawley.

McKINLEY & LARSEN.
Attorneys at Law.

General practice in all courts.

Rooms 1 and 2, Commercial & Savings Bank building, Twin Falls, Idaho.

J. H. Wise, Lawyer.

Twelve Years' Experience.

Practices in all courts and before land department in Washington, D. C.

Offices, rooms 4 and 5 over Commercial & Savings Bank, Twin Falls, Idaho.

BALL BROTHERS.
CONTRACTORS

Architectural Work a Specialty. See us for Plans and Estimates.

Ninth Avenue, between Tenth and Eleventh Sts. TWIN FALLS IDAHO

J. E. HAYES
Civil Engineer

Phone 73

TWIN FALLS, IDAHO

CHAS. H. MULL
Civil Engineer.

County Surveyor. City Engineer

Office First National Bank Building

P. O. Box 230, Telephone 113

BERG & WARDWELL
Civil & Electrical Engineers

Drafting. Blue Printing.

Manufacturer's agent for standard power and drilling machinery.

Over First National Bank.

H. E. HUNT
Undertaker and Embalmer

Open Day and Night. All Calls Promptly Attended To.

In Harder Building, on Tenth Avenue TWIN FALLS.

UNDERWOOD TYPEWRITER CO.
Supplies and Stationery.

C. W. LAWRENCE.
BOISE, : : : : IDAHO

L. J. Miller
Funeral Director and
Furnisher

Two Doors West of Hotel Perrine.
Lady Attendant.
Service Chapel with Private Room for Families.
My Personal Services to Care and Detail, including Cemetery Arrangements.
Private Ambulance.
Telephone Day or Night, 103.

For Photos
True to life
Go toBISBEE'S
Electric
Studio

Twin Falls, Idaho.

CHARLIE'S
STAR
RESTAURANT

Best Meal
in the City
for

25 cents

FOR SALE

CHEAP—if Taken At Once.

A quarter section of smooth, well located land in Miller tract on North Side. See or write.

TWIN FALLS NORTH SIDE REALTY CO.

Jerome : : : : Idaho.

When you want
a dray phone

142

Miller & Warberg

Office opposite Idaho Department Store.

H. N. HAMPTON
DEALER IN NEW AND SECONDHAND FURNITURE, CARPETS, STOVES AND ETC.

MAIN ST. Twin Falls Idaho.

CROPS NEVER FAIL ON CALIFORNIA IRRIGATED LANDS.

We have 2400 acres in the best section of California which we are selling in 10 to 20 acre tracts direct to settlers. Full description and price for the asking. Irrigated Land Company of California, 505 J. St., Sacramento, California.

FOR SALE OR TRADE FOR FARM LAND.

A new Stock of Merchandise and buildings. For particulars address.

J. A. JELLSON.

Whitney, Ore.

Cisterns—Sewers—Excavations.

Stone, cement or brick cisterns built to order. Satisfaction guaranteed.

Prices reasonable. Experienced builders. Contracts taken for excavation and sewer installation. Address Theodore Wicks & Co., Care Missouri Land Co., Commercial and Savings bank building, Twin Falls, Idaho.

Just your bargains with the Don Bryan Realty Co.

BREVITIES

Mr. and Mrs. Tish are stopping at the Hotel Perrine, pending completion of their residence.

Mr. and Mrs. Elmer E. Critchfield of Chicago, who have been the guests of Mr. and Mrs. C. J. Hahn, left for their home on Sunday. While here Mr. Critchfield died on a farm on the North side and is now a full fledged booster.

J. A. Sinclair, manager of the clothing department of the City Department store, left the city Monday evening for Astoria, Wash. Mr. Sinclair was called there on account of the sudden death of his brother. He was accompanied by Mrs. Sinclair.

The billiard and pool tables for the Commercial club have arrived and the room in the Smith building will soon be ready. Secretary Bainbridge is kept busy looking after the correspondence and other matters connected with the club work. The house warming will take place shortly.

The eastbound passenger train now leaves Twin Falls at 5:45 in the morning, 45 minutes later than before. The time of departure from Buhl is also 45 minutes later, making it 6:45 a. m. The accommodation train, eastward, was to leave Buhl at 2:30, but was delayed by the change in time.

Mrs. Frances Duncan, wife of Alvin Duncan, of Rock Creek, died at her home Thursday morning, aged 58. Mrs. Duncan had been ill but a short time, death occurring from heart disease. Besides her husband, Mrs. Duncan is survived by seven children. The funeral will probably be held Sunday afternoon and interment will be in the Rock Creek cemetery. L. J. Miller of Twin Falls has charge of the arrangements.

F. A. Raymond and A. O. Jones, representatives of "Ellors" big piano store, are putting in a line of pianos in the Lavering's furniture store such as has never been displayed in this section of the state. From this line the music covers, regardless of taste, should be easily suited, both as to price and quality. The terms are very alluring and with so many high grade pianos to choose from the line should be cut down very rapidly. The pianos are on view in Lavering's store.

M. H. Pape is building a carpenter and machine shop on north Main street which he expects to complete within a week. He will equip the shop with a planer, lathes, saw sharpener, band and rip saw and other appliances used in woodwork. The building covers a ground space 24 x 36 feet and when "Dad" gets through with it up it will be complete in every detail. Mr. Pape is an expert woodworker and one who have engaged him can testify, and he should see his hands full when his shop is ready.

President F. J. Johnson of the First National bank stopped over in Twin Falls on Wednesday and Thursday en route to Washington, where he will attend the meeting of governors of the white house as a delegate from Idaho. The other delegates are E. E. Hoover of Boise and Fretwell Hill of Twin Falls. Mr. Hoover will accompany the governor and Mr. Hill will go to Washington from Pittsburgh where he is at present. This will be the most notable gathering yet held in the national capital and held good should result therefrom. It was called for the purpose of conserving the natural resources of the nation and every state in the union will be represented.

The Ladies' Aid society of the Presbyterian church will meet next Thursday afternoon with Mrs. M. J. McCaw.

A social will be held in K. P. hall Saturday evening for the members of the Presbyterian church and their friends. The affair will be in charge of the Ladies' Aid society.

J. C. Beauchamp of Bedford, Iowa, brother-in-law of C. A. McMASTER, is the city and will assist Mr. McMASTER in his real estate business until after the opening of the Salmon project on June 1.

Mr. and Mrs. George B. Bania moved this week into their new home at the corner of Ninth street and Fifth avenue. The house, which is of a bungalow style, consists of five rooms, bath, etc., and is modern in every respect.

Dr. M. Stearns has purchased the residence on Shoshone avenue belonging to Dr. Gliffen. Dr. Stearns comes from Emmet where he has been practicing for the past two years. He will be making a practice in the future and conduct a general practice.

There will be a meeting of the Poultry association in K. P. hall Saturday afternoon at 2 o'clock. All interested in the raising of fancy stock are requested to be present. Plans will be made for a poultry show to be held in this city sometime during the winter months.

I. B. Perrine and daughter, Miss Stella, left on Tuesday for the east where Mr. Perrine will remain for some time on business connected with the Chicago and Northern Pacific railway.

A. P. O. E. Chapter was organized last Monday afternoon at the home of Mrs. A. N. Sprague. Mrs. Carrie Peterson, supreme president from Aurora, Neb., and Mrs. Lillian P. Parham of Portsmouth, Neb., assisted in the forming of the chapter. The chapter starts off with 11 members.

Miss Grace A. Kiersted is visiting at the home of Mr. Robert Brown at Rock Creek for the summer. Miss Kiersted is recuperating from her recent illness and she will take a long rest before returning to work. She could scarcely have chosen a more ideal home.

C. D. Anderson of Jacksonville, Ill., an expert watchmaker, jeweler and engraver, has purchased the stock and good will of M. Musgrave on south Main street. Mr. Anderson will shortly bring his family to Twin Falls as he intends to make this city his home. He is a leader in his business and he considers Twin Falls the best field he has seen.

Rev. Ray Beauchamp of Bedford, Iowa, preached his first sermon as pastor of the Christian church last Sunday morning. Mr. Beauchamp resigned his pastorate at Kidder, Mo., to come to Twin Falls. He is a young man and a graduate of the Drake University of Des Moines, Iowa. He was accompanied to Twin Falls by his brother, Homer, who has been assistant secretary of the Y. M. C. A. of Galveston, Texas.

W. Z. Smith and J. W. D. Smith of Chicago, who recently purchased the lot on Ninth street which Biabac's studio was until recently located, are about to let a contract for a building 25 x 45 feet, in which they will conduct a bakery. The firm will be known as Smith & Smith and it will conjure a straight bakery without any side attachments. The members of the new firm, who are brothers, have been engaged in the same business in Chicago and they intend to bring out an expert baker from that city.

The Syracuse club met at the home of Mrs. Clouck Tuesday afternoon. The roll call was responded to by quotations from William Cullen Bryant. The remainder of the afternoon was spent in discussing plans for the coming season.

Rev. A. A. Layton of Denver, is in the city to take charge temporarily of the Baptist church. Rev. Layton having been appointed to take charge of the district missionary work. There will be a business meeting of the members of the church at the home of H. H. Clouck on Saturday afternoon at 5:30.

The freight shipments from Twin Falls during the month of April exceeded those during the same month last year by 200,000 pounds. The number of cartloads of freight received in the month of April was 1,200, an increase of 103 cars over April of last year. The increase in cash receipts over last April was \$17,561.74, all of which shows that Twin Falls is "going some".

Excavation is being made by the Twin Falls Investment Co. for a building 24 x 135 feet on the east corner of Main and Seventh streets, to be occupied by the Investment Co., the Twin Falls Land & Water Co., and probably the Great Shoshone & Twin Falls Water Power Co. It is possible that the ground space may be enlarged, plans for that and now being under consideration.

Mrs. Carl J. Hahn left on Tuesday with Carl, Jr., for a visit with friends and relatives in Nebraska and Illinois. Mrs. Hahn is a well known resident of Twin Falls. Since their departure Carl has been moping around like a lost soul. He watches nervously for the telegraph messenger and scans the papers for news of train wrecks. Nobody blames him and all hope that he will have no cause for alarm.

The Iris theater is fast winning favor by its excellent programs and good management. The pictures run smoothly and clear and the performances are given with commendable color. Manager Denoit has not made a slip since he opened and has demonstrated that he is a master of the business. Every picture introduced is a three act play and the week to the excellent accompaniments by Willie Coburn. For next week some striking pictures have been secured which are certain to attract much attention.

The Dime theater (formerly the Majestic) is more than sustaining its good reputation in its new quarters in the Bryant block on Main street. The management had some difficulty with new lenses which cast too large a picture but they have overcome it by the substitution of a lens which fit the building exactly. The pictures this week have been excellent and those for next week promise better. Miss McGuffin, songs are winning nightly applause and Miss Fargo's piano playing is, as usual, a feature without which the performance would greatly suffer.

R. C. Beach, president of the Idaho Department Store company, has been in Twin Falls for several days, looking after his interests here which are constantly growing. With each visit to Twin Falls Mr. Beach's enthusiasm increases. He has made some splendid investments in real estate and farm property which would yield him handsome returns at present if he cared to realize. Mr. Beach is conceded to be one of the shrewdest and most successful buyers of goods in the west and he is just as good judgment in purchasing retail. The Department store is exceeding his expectations and he is taking a pride in stocking it with the best goods obtainable.

The W. C. T. U. met on Tuesday afternoon at the home of Mrs. Felt and installed the following officers: Mrs. Anne Evans, vice president at large; Mrs. May (Granger), recording secretary; Mrs. Alice Schwab, treasurer. The attendance was encouraging and the interest was splendidly sustained. An excellent program will be given at the next meeting on Monday, May 25.

STREETS ARE TO BE RE-NAMED

Avenues Will Parallel Shoshone and Streets Parallel Main.

At its meetings on Monday and Wednesday nights the city council awarded the contract for street sprinkling to A. S. Peterson, at \$4 per day for man and team; granted a right of way for a sliding screen, Ninth and Eleventh avenues for the elevator to be erected by the Mullen brothers of Denver; purchased a horse and wagon for the street commissioner; ordered the installation of an arc light at the junction of Ninth and Eleventh avenues; granted a saloon license to L. S. Pratt; ordered the Waterworks company to put a check in the low line canal to maintain pressure; created the office of planning inspector and appointed Fred Ramsey inspector; appointed a dog catcher and instructed him to get after the dogs and ordered a device for mending fire hose. It was decided to make the city a "no smoking" city, making the avenue near Shoshone and the streets parallel with Main street. Roughly speaking the city will be divided into four sections, radiating from the junction of Main street and Shoshone avenue, the names of these two thoroughfares remaining the same. In the northeast section, the first street parallel with Main street will be called First Street, Northeast and the same rule will apply to the avenues. Thus the first avenue parallel with Shoshone on the northeast will be First Avenue, Northeast, etc. The street corners will be placarded and the numbers will run 100 to the block.

Notice of Dissolution.

The firm of Sweet & Gaut has dissolved partnership this date. Mr. Gaut having purchased Mr. Sweet's interest in the firm. All accounts owed by the firm of Sweet & Gaut will be paid by Mr. Gaut and all accounts due the firm of Sweet & Gaut may be paid to Mr. Gaut.

O. M. GAUT,
L. L. SWEET.
Twin Falls, Idaho, May 5, 1908.
May 7-16-02.

FOR SALE OR RENT—Two farms near Buhl, one 155 acres, the other 160. Will sell or make satisfactory arrangements for leasing. Address E. W. —, 4229 Drexel—Riverside Chicago, Ill.

L. P. Clifton, Architect.

There is scarcely anything of such great importance to a city as the proper construction of its business buildings and their artistic effect, consequently much responsibility rests upon the shoulders of the members of the building trades, but in no small degree are the architects responsible. Few things affect the prosperity of a city more convincingly than a stranger than a modern and artistic business center. An architect who is among the leaders in his profession and who has been the guiding spirit in a number of the leading cities where he has lived, is L. P. Clifton, who recently came to Twin Falls from Tulsa, Oklahoma, where he left many monuments to his talent. Mr. Clifton, who has secured office room with W. D. Garlock & Co., has had many years experience in his profession and his work shows him to be a master. He understands western requirements, both as to construction, and material. During the past nine months he has supervised reinforced concrete construction in San Francisco, where this class of work has been developed to the highest degree. Mr. Clifton brings to Twin Falls the latest and best ideas of modern building in the utility of native material and he is prepared to do his share toward building this city to the most substantial and artistic lines.

The Don Bryan Realty Co. will locate on the Salmon river land and guarantee satisfaction, for 50 cents per acre.

If you want to sell, see Carter, Clear & Wright. If you want to buy, see Carter, Clear & Wright.

Rock Spring Peacock Coal
We also carry charcoal for domestic purposes.

FILER COAL COMPANY.
PHONE 4.

Shoshone Spray Ice Cream
HARDER BROS. BEST.

At All Soda Fountains in Twin Falls. Private orders by mail or telephone promptly filled.
TELEPHONE No. 55.



A Good Bank Balance

Is a sure sign of independence. We would like to have you open an account with us, and now is a good time to begin. We pay interest on time deposits.

SAFE DEPOSIT BOXES FOR RENT.

The Commercial & Savings Bank

L. A. WARNER, Cashier.

NEW SHOE SHOP

I have again opened up a shoe shop in the Famous Shoe Store and can be found there ready to do your repairing. Satisfaction guaranteed and prices right.
JENS PEDERSON.

Shoshone Spray Ice Cream

At All Soda Fountains in Twin Falls. Private orders by mail or telephone promptly filled.
TELEPHONE No. 55.

Buy Clothes With Your Eyes Open

HAVE YOU BEEN BUYING CLOTHES WHERE THE SALESMAN OR THE DEALER PUTS THE COAT ON YOUR BACK, GIVES IT A HITCH HERE AND A PULL THERE, PASSES HIS HAND OVER YOUR BACK AND SHOULDERS AND SAYS "WHAT A BEAUTIFUL FIT"? WELL, THAT'S ONE WAY OF SELLING CLOTHES AND ONE WAY OF BUYING THEM; BUT A FAR BETTER WAY, ACCORDING TO OUR METHOD OF THINKING, IS CHOOSING A SIZE-SUITED TO THE CUSTOMER AND GIVING HIM A COAT TO SLIP ON HIMSELF—A COAT THAT SETS PERFECTLY THE MOMENT HE PUTS IT ON—WHOSE COLLAR SETS CLOSE TO THE SHOULDERS, AND THAT SEEMS MOULDED TO THE FORM, A GARMENT THAT DRAPES AND FITS AS ONLY PERFECTLY MADE CLOTHES CAN FIT.

What's more you will find that a SINGERITY or a HART, SCHAFFNER & MARX coat will hold its shape; it will seem remarkable to you if you have been wearing coats that have been pulled into shape by the flatiron; that lose their good points after you have worn them for a brief time.

Profit by experience and let value enter into your calculations.

ELDRIDGE'S

\$2,000 GIVEN AWAY

TO THE PERSON DRAWING THE 50TH NUMBER OUT OF THE BOX.

If you want the \$2,000 or to buy as good a stallion or Jack as ever came over the Rocky Divide read what I have to say:

I will make the season of 1908 in Twin Falls at the Breeder's Corral across 13th avenue, opposite Gallithers Livery barn, with my Famous Registered Morgan Stallions and the Great Percheron Horse, King Brilliant, the premium winner, also Honest Bob, the Kentucky bred mammoth Jack. The season will last from March 1st to Sept. 1st, 1908.

Terms of Service. \$10.00 cash for season, and for every mare bred, the owner will be entitled to a drawing number and the holder of the lucky number will get the choice of either of the following:

Frank E., the Registered Morgan Stallion, winner first premium Sweepstakes & Silver medal at Nebraska and Iowa State Fairs, over all in his class, either in German, French or American coach and roadsters.

King Brilliant, the magnificent Percheron, or Honest Bob, the Kentucky Mammoth Jack.

We will give reasonable terms to parties wishing to insure mare in foal or living colt.

We will have the drawing on the first day of September, 1908 and on the same day will sell at auction to the highest bidder the stallions or Jack now owned by me, after the selection of the lucky number. I will offer on the same day \$15 each for the best colt from each horse or Jack that I now own.

Colts to be the got of last year's breeding. One or two years' terms will be given on the Stallions sold at auction at 10 per cent with good security.

Don't forget the 1st day of September, 1908 this date for the drawing of the \$2000 Stallion, the premium awarded to the best colts and the auction sale of the Registered Morgan Stallion, King Brilliant the Percheron, and the Kentucky bred Mammoth Jack. All are as good as the best. If you miss this sale you will miss bargains.

DOC. HEDRICK, Attendant. C. A. McMASTER, Owner, Twin Falls.

STOP! LISTEN! READ!

The Farmers Real Estate Co.

Office in Postoffice Building
Where the best bargains in the Twin Falls tract in ranch land and city property will be at our disposal. We will also buy and sell horses and try to keep on hand the BEST GRADE OF DAIRY COWS that we can get.

We welcome the farmer, the laborer, the business man and the investor to our office. Make known your wants whether you want to buy or sell and we are at your service to make the best possible deals for you. As we are from Missouri, we are the boys that can show you the BEST BARGAINS to be had on the Twin Falls tract.

OUTSIDE CORRESPONDENCE SOLICITED AND PROMPT ATTENTION GIVEN TO ALL INQUIRIES.

REFERENCES—ANY BANK IN TWIN FALLS.

Capital Stock \$50,000 Yours for business,
WHITE & McMASTER.

TWIN FALLS NEWS

George B. Fraser, Editor.

Published every Friday by
THE NEWS PUBLISHING COMPANY
TWIN FALLS, IDAHO.Subscription Rates.
One Year, in Advance.....\$1.00
Six Months, in Advance......50

Reliable information regarding the city and country promptly and confidentially furnished. Address communications to The News Publishing Company, Twin Falls, Idaho.

Entered as second-class matter, December 2, 1904, at the postoffice at Twin Falls, Idaho, under Act of Congress of March 3, 1879.

Notice for Publication—Final Proof. I, Samuel D. Clifton, of Twin Falls, Idaho, assignee of Charles H. Mull, who made entry No. 1891, under the provisions of an act of the legislature of the state of Idaho, commonly known as the "Caray act", approved March 2nd, 1899, which embraces lot 9 and SW $\frac{1}{4}$ of NE $\frac{1}{4}$ of section 23, township 10 S., range 19 E. B. M., do hereby give notice of my intention to make final proof to establish my claim to the land above described, and that I expect to prove that I have re-sold on reclaimed and cultivated said land as required by law, before E. B. Williams at Twin Falls, Idaho, on the 9th day of May, 1908, by two of the following witnesses: J. Barnes, of Hansen, E. V. Borg, Charles H. Mull and Harry Ball of Twin Falls, Idaho.

SAMUEL D. CLIFTON, Entryman.
Deferred until May 16th, 1908.

Peking ducks, Toulouse geese, all the leading laying strains of hens; eggs and fowls for sale. Mrs. Orla Syster, Clear Lake, Idaho, five miles north of Buhl.

Notice for Publication—Final Proof. I, Marlin J. Sweeley, of Twin Falls, Idaho, who made entry No. 2026, under the provisions of an act of the legislature of the state of Idaho, commonly known as the "Caray act", approved March 2nd, 1899, which embraces the SE $\frac{1}{4}$ of NW $\frac{1}{4}$; NE $\frac{1}{4}$ of SW $\frac{1}{4}$ and the W $\frac{1}{2}$ of SE $\frac{1}{4}$ of section 13, township 9 S., range 13 E. B. M., do hereby give notice of my intention to make final proof to establish my claim to the land above described, and that I expect to prove that I have resold on reclaimed and cultivated said land as required by law, before E. B. Williams at Twin Falls, Idaho, on the 8th day of June, 1908, by two of the following witnesses: Everett M. Sweeley, Harry E. Lewis, Alva A. Slocumb, of Twin Falls; and Albert N. Ring of Buhl, Idaho.

MARLIN J. SWELEY, Entryman.
Bungalow plans furnished for \$15 and upwards. L. P. Clifton, architect. Office with Garlock & Co., Twin Falls.



IF YOU WANT STYLISH SPRING SUITS—WE HAVE THEM.

They're not only stylish, they're quality productions. To prove that, we need only to point to the label on each garment

THE PALMER GARMENT

Don't forget that we are carrying the swellest line of Millinery in Southern Idaho, at prices that can't be duplicated. The Celebrated W. B. Corsets in pleasing styles.

LADIES EMPORIUM

PIKE BUILDING, MAIN ST., TWIN FALLS IDAHO.

Its Economy!
TO HAVE YOUR FAMILY WASHING DONE AT THE
Falls Steam Laundry
SAVES Trouble and backaches. Soap and fuel. The fumes and muss of wash day. You will feel brighter and have a pleasant smile for husband. Called for and delivered sweet and clean. PHONE 66.

ANHEUSER BUSCH and BUDWEISER
ON DRAUGHT

ENJOY A ST. REGIS HIGHBALL AT THE ST. REGIS BAR

MOORE & WAMSLEY
Proprietors TWIN FALLS, IDAHO

THE NEW JEWELER

Having purchased the entire stock of M. Musgrave, Jeweler, I will endeavor to give the people the best to be had in my line. Fine Engraving, Watchmaking and Repairing. Call and convince yourself

C. D. ANDERSON 913 MAIN STREET
TWIN FALLS, IDA.

LOOK! LOOK!!

RESIDENCE LOTS CLEARED, CESSPOOLS AND CELLARS DUG. ODD JOBS OF ALL KIND PROMPTLY ATTENDED TO.

ADDRESS
J. R. JOHNSON
GENERAL DELIVERY, TWIN FALLS, IDAHO.

PROFESSIONAL CARDS

EDWARD E. GARRETT.
Land Attorney.

For nine years receiver U. S. Land Office, Boise. Practices in all matters relating to public lands.
Boise City National Bank Bldg.
BOISE, IDAHO.

D. W. BRUNK

LICENSED AUCTIONEER
Fifteen Years' Experience.
Satisfaction guaranteed.
Office upstairs in Fox Building, Main Street, Twin Falls.

H. G. MUNYON

Licensed Auctioneer.
Satisfaction guaranteed or no charge. Fifteen years experience.
FILER : : : : IDAHO.

L. P. Clifton, Architect.

Plans, specifications and estimates furnished on public buildings, bungalows, etc.
Office with Garlock & Co.
Twin Falls, IDAHO.

BABCOCK, WINN & PENNOCK.

Estimates Furnished.
Box 231, Twin Falls, Idaho.

ATWOOD FELT COMPANY.

Building Contractors.
Office and Shop corner Shoshone Ave. and Fourteenth St.
PHONE : : : : 178.

SECRET SOCIETIES

TWIN FALLS LODGE.
NO. 46, A. F. and A. M.
Regular meetings held the first Monday of each month. Sojourning brethren cordially welcome.
B. A. BAKER, W. M. CHAS. H. MULL, Secy.

M. W. A. CAMP NO. 10890.
Meets 2nd and 4th Wednesdays of each month.
J. M. ROGERS, Consul.
D. W. BRUNK, Clerk.
Phone 123 Idaho Dept. Store Bldg.

TWIN FALLS CHAPTER, O. E. S.
Meets second and fourth Mondays in every month in K. of P. hall.
Matron, MRS. J. B. ELLIS.

TWIN FALLS LODGE NO. 23, I. O. O. F., instituted 1906.
Meets every Thursday evening at 7:30. Visiting brothers always welcome.
C. B. CARTWRIGHT, H. A. CRYDER, Noble Grand. Secretary.

NOTED CAPITALISTS COMING

Will arrive in Twin Falls Saturday, May 23.

Three private cars, bearing bankers and heads of bond houses from Chicago, St. Paul, Minneapolis, Omaha, Cleveland, St. Joseph, St. Louis, Kansas City and elsewhere, will leave Chicago on the evening of May 19, bound for Twin Falls. With the party will be J. G. White, head of the contracting firm of J. G. White & Co., New York, the largest in the world. It is also likely that Tom R. Johnson, the famous mayor of Cleveland, and David R. Francis of St. Louis will be among the visitors.

The visitors are coming to look over irrigation investments and to make personal inspection of the Twin Falls and Salmo tracts. They will spend a week in southern Idaho. It is possible that Leslie M. Shaw, former secretary of the treasury, will join the party in Chicago.
President C. B. Hutt of the Twin Falls Investment Co., while on his recent trip through the east, called upon the gentlemen who are coming and invited them to make the journey to Idaho. He succeeded in interesting them to such an extent that they agreed to devote a week to this section of the state. Their coming will be awaited with keen interest as it means a great deal to Twin Falls.

Scaled Proposals.
Sealed proposals will be received at the office of the clerk of the board of trustees of Kimberly School District No. 6, Kimberly, Idaho, up to and until the hour of 1 o'clock May 23, 1908, for furnishing all material and doing all labor necessary to construct an electric room, graded school building, in accordance with plans and specifications prepared by J. E. Tourtellote & Co. architects, Boise, Idaho. A certified check made payable to the school district in the sum of one hundred (\$100.00) dollars shall accompany each general proposal as a guarantee that successful bidder will enter into a contract with the board and will furnish a satisfactory bond for the performance of same.

The right is reserved to reject any or all bids submitted. Plans may be seen at the home of the clerk and at the office of the architects.
(Signed) MARTIN SULLIVAN, Clerk.

May 5-15-23

The Don Bryan Realty Co. will locate you on Salmo river land and guarantee satisfaction for 50 cents per acre.

Bungalow plans furnished for \$15 and upwards. L. P. Clifton, architect. Office with Garlock & Co., Twin Falls.

For information about Twin Falls, write the Don Bryan Realty Co.

PROFESSIONAL CARDS

DR. H. W. CLOUCHEK
Physician and Surgeon

Two Years Resident Physician at University of Michigan, Ann Arbor, Michigan.
TWIN FALLS CITY, IDAHO

DR. J. R. MORGAN

Physician and Surgeon
Graduate of Northwestern University Medical School of Chicago.
Office in Smith-Bradley Bldg. opp. Hotel Perrine.

H. Schmalhausen.

Physician & Surgeon.
Oculist & Aurist.
Office, ground floor, next door to Palace Meat Market.

DR. J. D. HUME

Osteopath
Office Phone 105.
Chronic diseases a specialty.
Office hours 9 A. M. to 4 P. M.

DR. D. BROWN LEWERS

DENTIST
Bradley & Smith Block, Opposite Hotel Perrine.
Graduate of Maryland.
Licentiate of Pennsylvania.
Phone No. 109

DR. H. T. BILLINGTON

Osteopath
Consultation Free.
Office in Stothard Bldg. Phone 62.
TWIN FALLS, IDAHO.

P. H. HALL

Contractor and Builder
Estimates cheerfully furnished
Twin Falls, Idaho.

SWELEY & SWELEY

Attorneys at Law.
Practice in all Courts.
TWIN FALLS : : : IDAHO

S. H. HAYS

Attorney at Law
321 Main street BOISE, IDAHO

HAWLEY, PUCKETT & HAWLEY

Rooms 1-3 Odd Fellows Bldg.
BOISE : : : IDAHO
Attorneys at Law.
Practice in all state and United States courts.

James H. Hawley, W. H. Puckett and Jess Hawley.

McKINLEY & LARSEN.

Attorneys at Law.
General practice in all courts and before land department in Washington, D. C.
Office, rooms 4 and 5 over Commercial & Savings Bank, Twin Falls, Ida.

J. H. Wise, Lawyer.

Twelve Years' Experience.
Practices in all courts and before land department in Washington, D. C.
Office, rooms 4 and 5 over Commercial & Savings Bank, Twin Falls, Ida.

BALL BROTHERS

CONTRACTORS
Architectural Work a Specialty. See us for Plans and Estimates.
Ninth Avenue, between Tenth and Eleventh Sts.
TWIN FALLS IDAHO

J. E. HAYES

Civil Engineer
Phone 73
TWIN FALLS, IDAHO

CHAS. H. MULL

Civil Engineer.
County Surveyor. City Engineer.
Office First National Bank Building
P. O. Box 230, Telephone 113

BERG & WARDWELL

Civil & Electrical Engineers.
Drafting. Blue Printing.
Manufacturers' agent for standard power and drilling machinery.
Over First National Bank.

H. E. HUNT

Undertaker and Embalmer
Open Day and Night.
All Calls Promptly Attended To.
In Harber Building, on Tenth Avenue
TWIN FALLS.

UNDERWOOD TYPEWRITER CO.

Supplies and Stationery.
C. W. LAWRENCE.
BOISE, IDAHO

L. J. Miller
Funeral Director and Furnisher

Two Doors West of Hotel Perrine.
Lady Attendant.
Service Chapel with Private Room for Families.
My Personal Services to Care and Detail, including Cemetery Arrangements.
Private Ambulance.
Telephone Day or Night, 103.

For Photos True to life Go to

BISBEE'S
Electric Studio

Twin Falls, Idaho.

CHARLIE'S
STAR RESTAURANT

Best Meal in the City for

25 cents

FOR SALE

CHEAP—If Taken At Once.
A quarter-section of smooth, well located land in Milnor tract on North Side. See or write, TWIN FALLS NORTH SIDE REALTY CO.
Jerome : : : IDAHO.

When you want a dray phone

142

Miller & Warberg

Office opposite Idaho Department Store.

H. N. HAMPTON

DEALER IN NEW AND SECONDHAND FURNITURE, CARPETS, STOVES AND ETC.
MAIN ST. Twin Falls Idaho.

CROPS NEVER FAIL ON CALIFORNIA IRRIGATED LANDS.

We have 2400 acres in the best section of California which we are selling in 5-10-20 acre tracts direct to settlers. Full description and price for the asking.
Irrigated Land Company of California, 605 J. St., Sacramento, California.

FOR SALE OR TRADE FOR FARM LAND.

A new Stock of Merchandise and buildings. For particulars address, J. A. JULLISON, Whitney, Ore.

Cisterns—Sewers—Excavations. Stone, cement or brick cisterns built to order. Satisfaction guaranteed.

Prices reasonable. Experienced builders. Contracts taken for excavations and sewer installation. Address Theodore Wickes & Co., Care Missouri Land Co., Commercial and Savings bank building, Twin Falls, Idaho.
List your bargains with the Don Bryan Realty Co.

Notice for Publication—Final Proof. Everett M. Sweeley, of Twin Falls, Idaho, who made entry No. 2026, under the provisions of an act of the legislature of the state of Idaho, commonly known as the "Caray act", approved March 2nd, 1899, which embraces the SE $\frac{1}{4}$ of SE $\frac{1}{4}$ of section 13, township 9 S., range 13 E. B. M., do hereby give notice of my intention to make final proof to establish my claim to the land above described, and that I expect to prove that I have re-sold on reclaimed and cultivated said land as required by law, before E. B. Williams at Twin Falls, Idaho, on the 8th day of June, 1908, by two of the following witnesses: Harry E. Lewis, Alva A. Slocumb, Albert N. Ring and Marlin J. Sweeley, all of Twin Falls, Idaho.

EVERETT M. SWELEY, Entryman.

Eggs for setting. Silver laid Wyandottes, \$1.50 for 15. Inquire Booth's Dry Goods Co., Twin Falls.

BREVITIES

Mr. and Mrs. Tush are stopping at the Hotel Portico, pending completion of their residence.

Mr. and Mrs. Elmer E. Critchfield of Chicago, who have been the guests of Mr. and Mrs. Carl J. Hall, left for home on Sunday. While here Mr. Critchfield filed on a farm on the North side and he is now a full fledged booster.

J. A. Sinclair, manager of the clothing department of the Idaho Department store, left the city Monday evening for Austin, Wash. Mr. Sinclair was called there on account of the sudden death of his brother. He was accompanied by Mrs. Sinclair.

The billiard and pool tables for the Commercial club have arrived and the rooms in the Smith building will soon be ready. Secretary Balabridge is kept busy looking after the correspondence and other matters connected with the club work. The house warming will take place shortly.

The eastbound passenger train now leaves Twin Falls at 6:45 in the evening, 45 minutes later than before. The westbound train leaves at 6:45 a. m. The accommodation train, eastward, was to have been set back two hours or more but the change in time has not been made.

Mrs. Frances Dunkan, wife of Albert Dunkan, of Rock Creek died at Shoshone Thursday morning, aged 58. Mrs. Dunkan had been ill but a short time, death occurring from heart disease. Besides her husband, Mrs. Dunkan is survived by seven children. The funeral will probably be held Sunday afternoon and interment will be in the Rock Creek cemetery. L. J. Miller of Twin Falls has charge of the arrangements.

F. A. Raymond and A. O. Jones, representatives of Ellors, big piano house, are putting a line of pianos in Lavering's furniture store, such as has never been displayed in this section of the state. From this line music lovers, regardless of taste, should be easily suited, both as to price and quality. The terms are very alluring and with so many high grade pianos to choose from the line should be cut down very rapidly. The pianos are on view in Lavering's store.

M. H. Pope is building a carpenter and machine shop on north Main street, which he expects to complete within a week. He will equip the shop with a planer, lathe, saw, sharpener, band and rip saw and other appliances used in woodwork. The building covers a ground space 24 x 40 feet and when "Dad" gets through fitting it up it will be complete in every detail. Mr. Pope is an expert in woodwork, as those who have engaged him can testify, and he should have his hands full when his shop is ready.

President F. F. Johnson of the First National bank stepped over in Twin Falls on Wednesday and Thursday en route to Washington, where he will attend the meeting of governors at the white house as a delegate from Idaho. The other delegates are E. B. Hoover of Boise and Fontress Hill of Twin Falls. Mr. Hoover will accompany the governor and Mr. Hill will go to Washington from Pittsburgh where he is at present. This will be the most notable gathering ever held in the national capital and under good should result therefrom. It was called for the purpose of conserving the natural resources of the nation and every state in the union will be represented.

The Ladies' Aid society of the Presbyterian church will meet next Thursday afternoon with Mrs. M. J. McCaw.

A social will be held in K. P. hall Saturday evening for the members of the Presbyterian church and their friends. The affair will be in charge of the Ladies' Aid society.

J. C. Beauchamp of Bedford, Iowa, brother-in-law of C. A. McMaster, is in the city and will assist Mr. McMaster in his real estate business until after the opening of the Salmon project on June 1.

Mr. and Mrs. George P. Banta moved this week to a new home at the corner of Ninth street and East avenue. The house, which is of a bungalow style, consists of five rooms, bath, etc., and is modern in every respect.

Dr. M. Stearns has purchased the residence on Shoshone avenue belonging to Dr. O'Brien. Dr. Stearns came from Emmett where he has been practicing for the past two years. He will open an office here in the near future and conduct a general practice.

There will be a meeting of the poultry association in K. P. hall Saturday afternoon at 2 o'clock. All interested in the raising of fancy stock are requested to be present. Plans will be made for a poultry show to be held in this city sometime during the winter months.

I. B. Perrine and daughter, Miss Stella, left on Tuesday for the east where Mr. Perrine will remain for some time on business connected with the Idaho-Nevada Southern railway and other enterprises in which he is interested.

A P. O. E. chapter was organized last Monday afternoon at the home of Mrs. N. Stearns. The chapter is composed of the following members: A. O. Jones, president; A. O. Jones, secretary; A. O. Jones, treasurer; A. O. Jones, members.

Miss Grace A. Kierstead is visiting at the home of Mrs. Robert Brown at Rock Creek for the summer. Miss Kierstead is recuperating from her recent illness and she will take a long rest before returning to work. She could scarcely have chosen a more ideal home.

C. D. Anderson of Jacksonville, Ill., an expert watchmaker, jeweler and engraver, has purchased the stock and good will of M. Muehle on south Main street. Mr. Anderson will shortly bring his family to Twin Falls as he intends to make this city his home. He is a leader in his business and he considers Twin Falls the best field he has seen.

Rev. Ray Beauchamp of Bedford, Iowa, preached his first sermon as pastor of the Christian church last Sunday morning. Mr. Beauchamp resigned his pastorate at Kidder, Mo. to come to Twin Falls. He is a young man and a graduate of the Drake University of Des Moines, Iowa. He was accompanied to Twin Falls by his brother, Homer, who has been assistant secretary of the Y. M. C. A. of Galveston, Texas.

W. Z. Smith and J. W. D. Smith of Chicago, who recently purchased a lot on Ninth street on which Smith's studio was until recently located, are about to let a contract for a building 25 x 45 feet, in which they will conduct a bakery. The firm will be known as Smith & Smith and it will conduct a straight bakery without any side attachments. The members of the new firm, who are brothers, have been engaged in the same business in Chicago and they intend to bring out an expert baker from that city.

The Synagogue club met at the home of Mrs. Clouchock Tuesday afternoon. The roll call was responded to by quotations from William Cullen Bryant. The remainder of the afternoon was spent in discussing plans for the coming season.

Rev. A. A. Layton of Denver, is in the city to take charge temporarily of the Baptist church. Rev. Schenck of the Presbyterian church has been appointed to take charge of the district missionary work. There will be a business meeting of the members of the church at the home of H. H. Sebeck on Saturday afternoon at 5:30.

The freight shipments from Twin Falls during the month of April exceeded those during the same month last year by 200,000 pounds. The number of carloads of freight received last month in Twin Falls was 229, an increase of 103 carloads over April of last year. The increase in cash receipts over last April was \$17,561.74, all of which shows that Twin Falls is "going some."

Excavation is being made by the Twin Falls Investment Co. for a building 24 x 125 feet, on the east corner of Main and Seventh streets. It is to be occupied by the Investment Co., the Twin Falls Land & Water Co. and probably the Great Shoshone & Twin Falls Water Power Co. It is possible that the ground space may be enlarged, plans to that end now being under consideration.

Mrs. Carl J. Hall left on Tuesday with Carl, Jr., for a visit with friends and relatives in Nebraska and Illinois. They were joined at Minot, N. D. by Mrs. Hall's mother, Mrs. M. M. Hall, and her departure Carl has been moping around like a lost soul. He watches nervously for the telegraph messenger and scans the papers for news of his mother. Nobody blames him and all hope that he will have no cause for alarm.

The Iris theater is fast winning favor by its excellent programs and good management. The pictures run smoothly and clear and the performances move with commendable celerity. Manager Beach has made a splendid record and has demonstrated that he is a master of the business. Boyd Linder introduced three splendid songs this week, to go to excellent accompaniment by Willie Coburn. For next week some striking pictures have been secured which are certain to attract much attention.

The Dime theater (formerly the Majestic) is more than sustaining its good reputation in its new quarters in the Bryan block on Main street. The management had some difficulty with new lenses which cast too large a picture but this will be overcome by the substitution of smaller lenses at the building. The pictures this week have been excellent and those for next week promise better. Miss McCrae's songs are winning plenty of applause and Miss Perry's piano playing is, as usual, a feature without which the performance would greatly be less.

R. C. Beach, president of the Idaho Department Store company, has been in Twin Falls for several days, looking after his interests here which are constantly growing. With each visit to Twin Falls Mr. Beach's enthusiasm increases. He has made some splendid investments in city and farm property which would yield him handsome returns if he cared to realize. Mr. Beach is conceded to be one of the shrewdest and most successful buyers of goods in the west and he uses just as good judgment in purchasing real estate. The Department store is exceeding his expectations and he is taking a pride in stocking it with the best goods obtainable.

The W. C. T. U. met on Tuesday afternoon at the home of Mrs. Folt and installed the following officers: Mrs. Anne Everett, president; Mrs. May Granger, recording secretary; Mrs. Alice Schwab, treasurer. The attendance was encouraging and the interest was splendidly sustained. An excellent program will be given at the next meeting on Monday, May 25.

STREETS ARE TO BE RE-NAMED

Avenues Will Parallel Shoshone and Streets Parallel Main.

At its meetings on Monday and Wednesday nights the city council awarded the contract for street sprinkling to A. S. Peterson, at \$4 per day for man and team. Granted a right of way for a sliding news stand, Tenth and Eleventh avenues for the elevator to be erected by the Mullens brothers of Denver; purchased a horse and wagon for the street commissioner; ordered the installation of an arc light at the junction of Ninth and Eleventh avenues; granted a saloon license to L. S. Pratt; ordered the Waterworks company to put a check in the low line canal to maintain pressure; created the office of plumbing inspector and appointed Ed. Ramsey inspector; appointed a dog catcher and instructed him to get after the dogs and ordered a device for mending fire hose. It was decided to remove and repave the streets, making the avenues run parallel with Shoshone avenue and the streets parallel with Main street. Roughly speaking the city will be divided into four sections, radiating from the junction of Main street and Shoshone avenue, the names of these two thoroughfares remaining the same. In the northeast section, the first street parallel with Main street will be called First Street, Northeast and the second street will be called Second Street, Northeast. The same rule will apply to the avenues. Thus the first avenue parallel with Shoshone on the northeast will be called First Avenue, Northeast, etc. The street corners will be placarded and the numbers will run 100 to the block.

Notice of Dissolution. The firm of Sweet & Gaut has dissolved partnership this date, Mr. Gaut having purchased Mr. Sweet's interest in the firm. All accounts owed the firm of Sweet & Gaut and they paid by Mr. Gaut and all accounts due the firm of Sweet & Gaut may be paid to Mr. Gaut.

O. M. GAUT, L. L. SWEET. Twin Falls, Idaho, May 6, 1908. May 7-15-22.

FOR SALE OR RENT—Two farms near Bull, one 156 acres, the other 160. Will sell or make satisfactory arrangements for leasing. Address E. W. Asay, 4320 Drexel Boulevard Chicago, Ill.

L. P. Clifton, Architect.

There is scarcely anything of such great importance to a city as the proper construction of its business houses and their artistic effect, consequently much responsibility rests upon the shoulders of the members of the building trades, but in no small degree are the architects responsible. Few things indicate the prosperity of a city more convincingly than a stranger than a modern and artistic business center. An architect who is among the leaders in his profession and who has been the guiding spirit in a number of the leading cities where he has lived, is L. P. Clifton, who recently came to Twin Falls from Tulsa, Oklahoma, where he left many monuments to his talent. Mr. Clifton, who has secured office room with V. D. Garlick & Co., has had many years experience in his profession and his work shows him to be a master. He understands the requirements, both as to construction, and material. During the past nine months he has supervised reinforced concrete construction in San Francisco, where this class of work has been developed to the highest degree. Mr. Clifton brings to Twin Falls the latest and best ideas of modern building in the utility of modern material and he is prepared to do his share toward building this city on the most substantial and artistic lines.

The D. B. Ryan-Ready Co. will locate you on Salmon river land and guarantee satisfaction for 50 cents per acre.

If you want to sell, see Carter, Clear & Wright. If you want to buy, see Carter, Clear & Wright.

Rock Spring Peacock Coal

We also carry charcoal for domestic purposes.

FILER COAL COMPANY PHONE 4.



A Good Bank Balance

Is a sure sign of independence. We would like to have you open an account with us, and now is a good time to begin. We pay interest on time deposits.

SAFE DEPOSIT BOXES, FOR RENT.

The Commercial & Savings Bank

L. A. WARNER, Cashier.

NEW SHOE SHOP

I have again opened up a shoe shop in the Famous Shoe Store and can be found there ready to do your repairing. Satisfaction guaranteed and prices right.

JENS PEDERSON.

Shoshone Spray Ice Cream

HARDER BROS. BEST.

All Soda Fountains in Twin Falls. Private orders by mail or telephone promptly filled. TELEPHONE No. 55.

Buy Clothes With Your Eyes Open

HAVE YOU BEEN BUYING CLOTHES WHERE THE SALESMAN OR THE DEALER PUTS THE COAT ON YOUR BACK, GIVES IT A HITCH HERE AND A PULL THERE, PASSES HIS HAND OVER YOUR BACK AND SHOULDERS AND SAYS "WHAT A BEAUTIFUL FIT?" WELL, THAT'S ONE WAY OF SELLING CLOTHES AND ONE WAY OF BUYING THEM; BUT A FAR BETTER WAY, ACCORDING TO OUR METHOD OF THINKING, IS CHOOSING A SIZE SUITED TO THE CUSTOMER AND GIVING HIM A COAT TO SLIP ON HIMSELF—A COAT THAT SETS PERFECTLY THE MOMENT HE PUTS IT ON—WHOSE COLLAR SETS CLOSE TO THE SHOULDERS, AND THAT SEEMS MOULDED TO THE FORM, A GARMENT THAT DRAPES AND FITS AS ONLY PERFECTLY MADE CLOTHES CAN FIT.

What's more you will find that a SINCERITY or a HART, SCHAFFNER & MARX coat will hold its shape; it will seem remarkable to you if you have been wearing coats that have been pulled into shape by the flatiron; that lose their good points after you have worn them for a brief time.

Profit by experience and let value enter into your calculations.

ELDRIDGE'S

STOP! LISTEN! READ!

The Farmers Real Estate Co.

Office in Postoffice Building

Where the best bargains on the Twin Falls tract in ranch land and city property will be at our disposal. We will also buy and sell horses and try to keep on hand the BEST GRADE OF DAIRY COWS that we can get.

We welcome the farmer, the laborer, the business man and the investor to our office. Make known your wants whether you want to buy or sell and we are at your service to make the best possible deals for you. As we are from Missouri, we are the boys that can show you the BEST BARGAINS to be had on the Twin Falls tract.

OUTSIDE CORRESPONDENCE SOLICITED AND PROMPT ATTENTION GIVEN TO ALL INQUIRIES. REFERENCES—ANY BANK IN TWIN FALLS.

Capital Stock \$50,000 Yours for business, WHITE & McMASTER.

PALACE BAR

Fine Wines, Liquors and Cigars.
A Meeting Place for the Boys.
MIXED DRINKS A SPECIALTY

L. S. PRATT, Prop.

TWIN FALLS CREAMERY

JACOBSEN & HOOPS, Props.

Anyone desiring milk cans or separators can secure them
of us at wholesale prices.

Cream gathered from Kimberly and vicinity on Monday and
Thursday; from Filer and vicinity on Tuesday and Friday; from
Twin Falls and vicinity on Wednesday and Saturday.

Shoshone Ave.

Near Depot.

R. A. CARTER

J. N. CLAAR

CARTER & CLAAR

Irrigated Fruit and Farm Lands.

Hay and Stock Ranches.

Acres and City Property

Office on Main St., Fourth door
west of postoffice Phone 165

TWIN FALLS, IDAHO.

Hundreds of Land Buyers

Will Visit

Twin Falls in the Next Thirty Days. If You
Wish to Sell Your Farm or City
Property, See

S. T. Hamilton & Co.

Twin Falls Investment Co.

LIMITED

Sole Agents for Water Rights for all Carey Act
Lands under the

GREAT TWIN FALLS CANAL SYSTEM

8,000 Acres of
Carey Act Land

Still open for original entry under this Canal
System

Land, 50 cents per acre. Perpetual water rights, \$25 per acre, ten
annual payments.

Vehicles from Buhl furnished free to those who desire to inspect
land. Prospective entrymen accompanied by competent landors.

BUHL

Buhl, located 17 miles west of the City of Twin Falls is the
leading city on the west end of the tract and the distributing point
for a large area, including the stock districts of Three Creek, Butte
and Roseworth, likewise the farming and fruit growing districts of
Hagerman, Kanoka, Flat and Salmon. The railway track is now
completed between Twin Falls and Buhl, and train service has be-
gun. Buhl has a splendid gravity system of waterworks, with a
pressure of 100 pounds in the business section. It will soon be
supplied with electric power and light. Business property values
in Twin Falls have increased 500 per cent in less than two years.
The same opportunities for investment are presented at Buhl. Now
is the time to buy. Write for literature and further information.
Address all communications to

Secretary, Twin Falls Investment Co., Ltd.

TWIN FALLS, IDAHO

Was Content to Return to Idaho.

(Continued From Page 3.)

ed on humanitarian principles, allow-
ing the prisoners work benches with
tools, and here they make fine articles
of the Mexican origin, and others make
dog collars, bridges, halters, and
and several very fine out of horse
hair. The prisoners sell these articles
to visitors and have the money to
help their families. The convicts are
mostly Mexicans. I did see one who
who seemed decidedly imprisoned.

Yuma is situated on the banks of
the silvery Colorado river, which has
been called the "Nile of America".
The river is 300 feet wide. The gov-
ernment's plan is to store and utilize
all surplus Colorado river water, and
distribute it where it is needed. The
Laguna dam, 13 miles northwest of
Yuma, furnishes two irrigating canals,
one on the Arizona side and one on the
California side. These canals
will open to irrigate 100,000 acres, in-
describably fertile, growing palm
olives, oranges, apricots, grapes, and
all sub-tropical products. These won-
derful irrigation projects will be the
means of converting areas of arid
lands into a perfect paradise.

On January 27th, at 10 p. m., I left
Mr. Burrington at Yuma and boarded
the train for my long journey east to
Asbury Park, N. J. On this tour
there was a personal conductor
furnished, to call out points
of interest. Our first stop was at El
Paso, Texas. This is a most beauti-
ful, modern city. The streets were
brilliantly illuminated with colored
lights, in harmony with the Mexican
taste, not to please tourists, but a
permanent custom. The crowd from
the train impeded the opportunity
of getting a good square meal, after
which our conductor piloted us to
many beautiful stores where the Mex-
ican fire opals can be bought for a
song. After purchasing souvenirs we
all returned to the train.

Some distance further we came up
on the second largest trestle work
bridge in the world, over the Pecos
river, 320 feet high or 150 feet high
than Shoshone falls. An orange
was dropped to the water, and nearly
lost sight-of before it reached the
river. The trestle work is 2100 feet
long. From here we traveled over
miles and miles of sagebrush (you all
know what that is) until San Antonio
was sighted. San Antonio is a very
wealthy city, displayed in many ways;
fine residences, modern skyscraper
buildings and most up-to-date depart-
ment stores. But most of all to be
proud of is the delightful climate,
bracing to the spirit and well suited.
Here we saw an old fortified mission
building, also went through a hall
with a collection of the most beauti-
ful horns I have ever polished and
mounted. From deer, elk, buffalo,
moose and Texas steers. We saw a
pair of elk horns measuring 15 feet
that money could not buy. This is
the most complete collection in America.
An eagle was made from the rattle
of rattlesnakes.

One day's ride took us across the
state of Louisiana through a low, marshy
country, but where many beauti-
ful trees, ferns and palms, such as
receive the most careful attention in
the homes of the northern states
can be seen growing wild in the woods
in great abundance just before reach-
ing New Orleans. We were ferried
across the Mississippi. Unfortunately,
a freight train was just ahead of
us, which caused us to be one hour
late, and we were only favored in
seeing the gorgeous river boats, bril-
liantly lighted, many very high build-
ings. We took with us no particularly
choice roadrunner or interested city
of the south. We then traveled from
New Orleans several hundred miles
along the coast of the Gulf of Mex-
ico, then on through North and South
Carolina and Alabama through var-
ious kinds of country, mostly low,
marshy, with apparently little civiliza-
tion, yet there were many cotton
fields, with "pumpkin colored coons"
in the foreground.

Historical Atlanta.
We arrived at Atlanta, Ga., on time,
allowing us one hour for sight-
seeing. Atlanta is a renowned his-
torical point of the civil war where
Sherman marched with his troops to
the sea. This brought about the song,
"Marching through Georgia." We
visited the old exposition grounds,
viewed the interior of the court house,
also the Carnegie public library, very
plain but full of fine books, and the
comforts of reading papers which is
a blessing to any place and it more
reading rooms on less elaborate plans,
were accessible even in smaller places.
I am sure there would be less time for
wickedness. After buying a few
cut flowers, which are extremely rea-
sonable in these southern cities, we
boarded the train once more, this
time for Washington. D. C., where
we arrived at 10:30 p. m. in a
black cold night, quite penetrating
weather compared with Sunny Cali-
fornia. Arriving at this late hour, and
soon to depart, I was unable to see
much of Washington. However, a few
of our crowd, who were en route for
Maine, and myself, strolled along to
the capitol building, and mounted the
balcony in the east wing. The high
piercing wind drove us back to the
depot. One could spend much time
in Washington to good advan-
tage. The Smithsonian museum, the
congressional library and many places
of interest could be visited. We crossed
the beautiful Potomac river just
south of the city. I boarded a train
on the Pennsylvania line at 11:30 p. m.,
changed at Trenton, N. J., and ar-
rived at Asbury Park at noon the fol-
lowing day.

Great Summer Resort.

Asbury Park is situated on the Jer-
sey shore 54 miles from New York
city. It is one of the most popular,
cleanest and moral resorts along the
Atlantic coast. The population in
summer is about 100,000, while in win-
ter it is nearly 9000. Its many ways
of entertaining the guests are strict-
ly first-class. At one of the largest
pavilions, Arthur Pryor's band of
New York is filled for the small sum
of \$15,000 for the season. Fine board

walks afford the people much pleasure
in viewing the ocean and the hundreds
of bathers. At Ocean Grove, just
across Wesley lake, the Methodists
great camp meeting grounds, is an
auditorium which seats 12,000 people.
A new pipe organ is just being placed
in this hall, at a cost of \$100,000, sup-
posed to be as the sea can be bought.
The very finest tenor is engaged to
appear in the auditorium during the
summer, free to all, if you care to go
and listen. A chorus of 600 voices
appears frequently. This sort of
amusement is different to the usual
lover or, I should say, to anyone. It
was my pleasure and privilege to take
several trips to New York. My nephew
deceived me about one day. We first
visited Arthur's tomb, a very beauti-
ful structure of granite, wherein the
bodies of Gen. Grant and his wife are
resting. This tomb is on the bank of
the Hudson. We took a car on the
subway and went to the Brooklyn
bridge, then over this bridge on the
elevated to Brooklyn, soon returning
by subway under the East river, then
up in the air 41 stories in the Singer
building. They say the Brooklyn
bridge has gone up, and the subway is
in a hole. This is a positive fact.
At Arthur's widow's apartment
Hippodrome, E. H. Southern in a new
popular play, and many of such at-
tractions, which would tempt me Twin
Falls people, were being played in
New York. After our home visit
with my dear old mother, who has
since passed away, I returned to Ida-
ho.

Homeward Bound.
From Asbury Park I went on the B.
& O. to Chicago, passing through
Philadelphia, Pittsburg, Baltimore,
Past John Brown fort and Harpers
Ferry. Here we began climbing the
Cumberland mountains, not quite as
high as the Rockies but more pic-
turesque. The country through Penn-
sylvania and Ohio is all exceedingly
fine. Most beautiful farm-homes and
orchards can be seen with a great
variety of landscape. The highest
point we reached on the Cumberland
mountains was Sandeapach, elevation,
1000 feet. This portion of my trip
was very pretty.

On arriving in Chicago, on Sunday
morning, where my home was for
about eight years, began to feel as
one we had returned home after
being gone for some time. My friends
had planned pleasure for me for every
minute of my brief visit. We started
right and went to hear Cassius
speak at the auditorium. He is just
as grand as ever. On Monday after-
noon my friend, who is a member of
the Chicago Culture club, had secured
a visitor's ticket previous to my
coming so I had the pleasure and
honor of being present, and an-
nounced as a visitor from Kimberly,
Idaho. This club has a membership of
one ladies. One of the prettiest fea-
tures on the programs was "Babes in
Toyland," a most interesting number
also the sopranos, a recitation by
Opheia Blair (her own composition).
She is a modern writer and fast be-
coming famous. The Comic Opera
"Robin Hood" was very delightfully
produced at the Auditorium. Of course
we had to see the "Merry Widow."
"The Man from Home." These were
all very fine, and a rare treat to a
resident of Twin Falls.

A shopping tour, and a lunch at
Marshall Field's were of course in
line, and a hunt for bargains, such as
can only be found in Chicago, were
made interesting and profitable.
One week later I boarded the Over-
land limited, for Minidoka, stopping
one day in Omaha, a very fine city
on the banks of the Mississippi.
Leaving Omaha at 1:30 p. m. on Tues-
day for a day's ride over the great
American desert to reach, once more,
the land of sunshine, Idaho.

"Kind Providence our lot has cast."
"And yet we have to choose our lot
at last."

"If you're inquiring where to go,
"Come down to southern Idaho."

Dick-Low Wheat.
Milner Porline-Lumber Co., Ltd. of
Buhl, Idaho, still have a limited amount
on hand.

Bisbee will go anywhere at any time
and take out door photos for you.

For fine views and postcards go to
Bisbee's.

FOR SALE—Second-hand Remington
typewriter, in first class condi-
tion.

Twin Falls Title & Abstract Co.,
Over First National Bank.

FOR RENT—A ranch, one and a
quarter miles from Buhl, 70 acres
cleared, 30 acres plowed, two-room
plastered house, and barn on easy
terms. Apply to F. S. Marshall, Buhl,
Idaho.

FOR SALE—A two gang 12-in.
Syracuse plow. It has been used but
one season plowing about 120 acres.
A No. 1 team of mares weight about
2300 pounds, six and eight years old.
Write or come to see.

J. E. Steinhour, Murtaugh, Ida.

Choice Seed Potatoes.
Burbank choice seed potatoes for
sale, 50c per hundred. See samples
and leave orders at Palace Meat Mar-
ket.

For out door photos of any kind see
Bisbee.

Excursions to Wallace, Idaho, May
9th and 10th.

For summer excursion convention.
One fare for the round trip to Hui-
ington plus \$13.25 beyond. Tickets
limited to May 20th. Special trains
will be operated from Pocatello to
Wallace several times which will be an-
nounced through agents later.

D. E. BURLIVAN, Agent, Twin Falls,
May 13.

Tools 8 x 10; 10 x 12; 12 x 14; 12
x 16 on sale at The Idaho Depart-
ment Store.

Everything in legal blanks at The
News office.

H. A. STROUD & CO.

Exclusive Real Estate and Investments.

Office in St. Régis Block
Shoshone avenue, Ground Floor.

We always have customers for land at its
present value.

H. A. STROUD & CO.

Who do as they advertise.

Abstracts of Title

FIRE INSURANCE

Twin Falls Title & Abstract Co.

OVER FIRST NATIONAL BANK.

PHONE 168.

The Largest Fire Insurance Agency in
Southern Idaho.

The Electric Mills

KIMBERLY, IDAHO

Will Pay or Contract the Highest Market Price for Wheat, Oats or
Barley. Call, write or telephone us.

THE T. & K. MILLING CO.

W. H. THO MAB, Manager.

Everybody Works but Father

He does nothing but run the bar at the Hotel
Perrine, Twin Falls. Only the choicest brands of
Wines, Liquors and Cigars

H. C. Sorenson & Co.

Hotel Perrine

RIGHT UP TO DATE

Steam Heat

Electric Lights

Sample Rooms

E. B. WILLIAMS, PROPRIETOR.

SEE
J. K. MARTIN

before building your elevators or having foundation
work laid. All work guaranteed and promptly at-
tended to. Address Twin Falls, Idaho or leave or-
ders at J. V. Marshall Real Estate office.

The Mission Cafe

The Best Restaurant in the City.
Everything New. Service Excellent.
Short Orders a Specialty.

: : : Opposite Postoffice : : :

| DESCRIPTION | | |
|-----------------------------|--|--------|
| Township 11 S., range 14 E. | | |
| Sec. 12, S½ | | 320 |
| Sec. 13 | | 640 |
| Sec. 24, all | | 640 |
| Sec. 25, all | | 640 |
| Township 11 S., range 15 E. | | |
| Sec. 1, all | | 639.80 |
| Sec. 2, all | | 639.28 |
| Sec. 3, all | | 639.68 |
| Sec. 4, all | | 638.48 |
| Sec. 5, S½ | | 320 |
| Sec. 7, lots 3 and 4 | | 75.50 |
| Sec. 7, E¼ of NW¼ | | 80 |
| Sec. 7, E¼ of SW¼ | | 80 |
| Sec. 7, E¼ | | 320 |
| Sec. 8, all | | 640 |
| Sec. 9, all | | 640 |
| Sec. 10, all | | 640 |
| Sec. 11, all | | 640 |
| Sec. 12, all | | 640 |
| Sec. 13, all | | 640 |
| Sec. 14, N½ | | 320 |
| Sec. 15, all | | 640 |
| Sec. 17, all | | 640 |
| Sec. 18, all | | 631.80 |
| Sec. 19, all | | 632.08 |
| Sec. 20, all | | 640 |
| Sec. 21, all | | 640 |
| Sec. 22, W¼ of NW¼ | | 80 |
| Sec. 22, W¼ of SW¼ | | 80 |
| Sec. 22, NE¼ of NW¼ | | 40 |
| Sec. 22, NE¼ of SW¼ | | 80 |
| Sec. 27, W¼ of SW¼ | | 80 |
| Sec. 28, all | | 640 |
| Sec. 29, all | | 640 |
| Sec. 30, all | | 632.40 |
| Sec. 31, all | | 633.04 |
| Sec. 32, all | | 640 |
| Sec. 33, N½ | | 320 |
| Sec. 33, N¼ of SW¼ | | 80 |
| Sec. 33, S¼ of NW¼ | | 80 |
| Sec. 33, SW¼ of SW¼ | | 40 |
| Sec. 34, W¼ of NW¼ | | 80 |
| Sec. 34, NW¼ of SW¼ | | 40 |
| Township 11 S., range 16 E. | | |
| Sec. 1, all | | 320 |
| Sec. 2, SW¼ of NW¼ | | 40 |
| Sec. 3, all | | 639.04 |
| Sec. 4, all | | 639.62 |
| Sec. 5, all | | 639.40 |
| Sec. 6, all | | 634.08 |
| Sec. 7, all | | 634.62 |
| Sec. 8, all | | 640 |
| Sec. 9, all | | 640 |
| Sec. 10, W¼ | | 320 |
| Sec. 10, W¼ of NE¼ | | 80 |
| Sec. 10, NE¼ of NE¼ | | 40 |
| Sec. 11, E¼ | | 40 |
| Sec. 11, E¼ of NW¼ | | 160 |
| Sec. 11, N¼ of SW¼ | | 80 |
| Sec. 11, SE¼ of SW¼ | | 40 |
| Sec. 12, SE¼ | | 320 |
| Sec. 12, SE¼ of NE¼ | | 160 |
| Sec. 13, all | | 640 |
| Sec. 14, E¼ | | 320 |
| Sec. 14, SW¼ | | 160 |
| Sec. 15, all | | 640 |
| Sec. 17, all | | 640 |
| Sec. 18, all | | 635.80 |
| Sec. 19, E¼ | | 320 |
| Sec. 19, E¼ of SW¼ | | 80 |
| Sec. 19, lots 1 and 2 | | 78.31 |
| Sec. 20, all | | 640 |
| Sec. 21, all | | 640 |
| Sec. 22, all | | 640 |
| Sec. 23, all | | 640 |
| Sec. 24, all | | 640 |
| Sec. 25, all | | 640 |
| Sec. 26, all | | 640 |
| Sec. 27, all | | 640 |
| Sec. 28, all | | 640 |
| Sec. 29, all | | 640 |
| Sec. 32, all | | 640 |
| Sec. 33, all | | 640 |
| Sec. 34, all | | 640 |
| Sec. 35, all | | 640 |
| Township 11 S., range 17 E. | | |
| Sec. 7, lot 2 | | 17.39 |
| Sec. 7, lot 3 | | 17.74 |
| Sec. 7, lot 4 | | 1.03 |
| Sec. 7, SE¼ of NW¼ | | 40 |
| Sec. 7, S¼ of NW¼ | | 80 |
| Sec. 7, E¼ of SW¼ | | 80 |
| Sec. 7, E¼ | | 160 |
| Sec. 8, S¼ | | 320 |
| Sec. 8, S¼ of NW¼ | | 80 |
| Sec. 8, S¼ of NE¼ | | 40 |
| Sec. 9, SW¼ of NW¼ | | 40 |
| Sec. 9, SW¼ of SE¼ | | 160 |
| Sec. 9, NW¼ of SE¼ | | 40 |
| Sec. 17, all | | 640 |
| Sec. 18, all | | 585.44 |
| Sec. 19, lot 1 | | 19.19 |
| Sec. 19, lot 2 | | 19.73 |
| Sec. 19, lot 3 | | 19.61 |
| Sec. 19, lot 4 | | 20.09 |
| Sec. 19, NE¼ | | 160 |
| Sec. 19, E¼ of NW¼ | | 80 |
| Sec. 19, E¼ of SW¼ | | 80 |
| Sec. 19, N¼ of SE¼ | | 80 |
| Sec. 20, N¼ | | 320 |
| Sec. 20, NE¼ | | 160 |
| Sec. 20, N¼ of SW¼ | | 80 |
| Sec. 21, all | | 640 |
| Sec. 22, all | | 640 |
| Sec. | | |

| DESCRIPTION | ACRE |
|-----------------------------|-------|
| Sec. 13, NW 1/4 | 320 |
| Sec. 13, NE 1/4 | 160 |
| Sec. 15, NW 1/4 of NE 1/4 | 80 |
| Sec. 16, SE 1/4 of SE 1/4 | 80 |
| Sec. 24, E 1/2 of NW 1/4 | 80 |
| Sec. 25, NE 1/4 | 160 |
| Township 12 S., range 16 E. | |
| Sec. 1, all | 638.2 |
| Sec. 2, all | 638.2 |
| Sec. 3, all | 636.6 |
| Sec. 4, all | 637.7 |
| Sec. 5, lot 1 | 39.7 |
| Sec. 5, lot 2 | 40.9 |
| Sec. 5, lot 3 | 39.5 |
| Sec. 5, lot 4 | 40.3 |
| Sec. 6, S 1/2 of NW 1/4 | 80 |
| Sec. 6, S 1/2 of NE 1/4 | 80 |
| Sec. 6, SE 1/4 of SE 1/4 | 40 |
| Sec. 6, SE 1/4 of SE 1/4 | 40 |
| Sec. 7, lot 1 | 39.4 |
| Sec. 7, lot 2 | 39.4 |
| Sec. 7, lot 3 | 39.5 |
| Sec. 7, E 1/2 of SW 1/4 | 80 |
| Sec. 7, W 1/2 of SE 1/4 | 80 |
| Sec. 9, NW 1/4 | 320 |
| Sec. 9, E 1/2 of NW 1/4 | 80 |
| Sec. 9, E 1/2 of SW 1/4 | 80 |
| Sec. 10, all | 640 |
| Sec. 11, all | 640 |
| Sec. 13, NW 1/4 | 320 |
| Sec. 14, SW 1/4 | 160 |
| Sec. 15, NE 1/4 | 160 |
| Sec. 15, NW 1/4 | 160 |
| Sec. 16, SE 1/4 of NW 1/4 | 80 |
| Sec. 17, NW 1/4 of NW 1/4 | 40 |
| Sec. 17, S 1/2 of NW 1/4 | 80 |
| Sec. 17, N 1/2 of SW 1/4 | 80 |
| Sec. 18, SE 1/4 of SE 1/4 | 40 |
| Sec. 18, all | 638.2 |
| Sec. 19, all | 639.1 |
| Sec. 20, NW 1/4 | 160 |
| Sec. 20, S 1/2 of NE 1/4 | 80 |
| Sec. 21, NW 1/4 | 160 |
| Sec. 21, S 1/2 of NE 1/4 | 80 |
| Sec. 21, S 1/2 of NW 1/4 | 80 |
| Sec. 22, SE 1/4 of NE 1/4 | 160 |
| Sec. 22, W 1/2 | 320 |
| Sec. 23, SE 1/4 | 160 |
| Sec. 24, NW 1/4 | 160 |
| Sec. 24, NW 1/4 | 160 |
| Sec. 26, W 1/2 of NE 1/4 | 80 |
| Sec. 26, W 1/2 of SE 1/4 | 80 |
| Sec. 27, E 1/2 | 320 |
| Sec. 30, SE 1/4 | 160 |
| Township 12 S., range 16 E. | |
| Sec. 30, E 1/2 of SW 1/4 | 80 |
| Sec. 31, E 1/2 | 320 |
| Sec. 32, S 1/2 | 320 |
| Sec. 34, all | 640 |
| Sec. 34, NW 1/4 | 160 |
| Sec. 35, W 1/2 of NE 1/4 | 80 |
| Sec. 35, W 1/2 of SW 1/4 | 80 |
| Township 12 S., range 17 E. | |
| Sec. 2, lot 1 | 35.9 |
| Sec. 2, lot 2 | 40.2 |
| Sec. 2, lot 4 | 40.7 |
| Sec. 2, S 1/2 of NE 1/4 | 80 |
| Sec. 2, E 1/2 of SW 1/4 | 80 |
| Sec. 3, all | 640.9 |
| Sec. 4, SE 1/4 | 160 |
| Sec. 4, SE 1/4 | 320 |
| Sec. 4, S 1/2 of NW 1/4 | 80 |
| Sec. 5, NW 1/4 | 160 |
| Sec. 10, NW 1/4 | 160 |
| Sec. 11, W 1/2 of NW 1/4 | 80 |
| Sec. 12, NW 1/4 | 160 |
| Sec. 17, E 1/2 of SE 1/4 | 80 |
| Sec. 18, S 1/2 of NE 1/4 | 80 |
| Township 13 S., range 16 E. | |
| Sec. 3, lot 1 | 38.8 |
| Sec. 3, lot 2 | 38.2 |
| Sec. 3, lot 4 | 38.2 |
| Sec. 4, S 1/2 | 320 |
| Sec. 4, S 1/2 of NW 1/4 | 80 |
| Sec. 4, all | 632.5 |
| Sec. 5, all | 632 |
| Sec. 6, lot 1 | 37.5 |
| Sec. 6, lot 2 | 37.5 |
| Sec. 6, lot 3 | 37.1 |
| Sec. 6, S 1/2 of NE 1/4 | 80 |
| Sec. 7, NE 1/4 | 160 |
| Sec. 7, S 1/2 of SE 1/4 | 80 |
| Sec. 7, S 1/2 of SE 1/4 | 40 |
| Sec. 7, lot 1 | 50.9 |
| Sec. 8, S 1/2 | 320 |
| Sec. 8, NE 1/4 | 160 |
| Sec. 9, all | 640 |
| Township 13 S., range 16 E. | |
| Sec. 10, W 1/2 of NE 1/4 | 80 |
| Sec. 10, W 1/2 of SE 1/4 | 80 |
| Sec. 10, W 1/2 of NW 1/4 | 80 |
| Sec. 15, NW 1/4 | 160 |
| Sec. 15, SW 1/4 | 160 |
| Sec. 16, W 1/2 of SE 1/4 | 80 |
| Sec. 18, E 1/2 | 640 |
| Sec. 20, all | 640 |
| Sec. 21, all | 640 |
| Sec. 22, W 1/2 | 640 |
| Sec. 27, W 1/2 | 640 |
| Sec. 28, all | 640 |
| Sec. 33, all | 640 |
| Township 14 S., range 15 E. | |
| Sec. 1, S 1/2 | 320 |
| Sec. 2, S 1/2 | 320 |
| Sec. 3, SE 1/4 | 160 |
| Sec. 10, E 1/2 | 320 |
| Sec. 11, all | 640 |
| Sec. 12, all | 640 |
| Sec. 13, all | 640 |
| Sec. 14, all | 640 |
| Sec. 15, all | 640 |
| Sec. 21, S 1/2 | 320 |
| Sec. 22, NW 1/4 | 160 |
| Sec. 23, NW 1/4 | 160 |
| Township 14 S., range 16 E. | |
| Sec. 3, S 1/2 of SE 1/4 | 80 |
| Sec. 3, S 1/2 of SE 1/4 | 80 |
| Sec. 3, S 1/2 of NW 1/4 | 160 |
| Sec. 3, SW 1/4 of NE 1/4 | 40 |
| Sec. 3, lot 1 | 39.3 |
| Sec. 3, lot 3 | 39.6 |
| Sec. 4, SE 1/4 | 160 |
| Sec. 4, NE 1/4 | 160 |
| Sec. 4, S 1/2 of NW 1/4 | 80 |
| Sec. 4, lot 1 | 39.7 |

FOR RENT—80 acres, one mile from Twin Falls. All in cultivation. Inquire Irrigated Lands Company.

Sold Potatoes.

Good choice Burbank and Peerless potatoes for sale. Maple Hill farm, T. W. Potter.

Any size lot! You have to want, we can furnish. We have in stock 8 x 10; 10 x 12; 12 x 14; 12 x 16 and all widths of duck. Idaho Department Store.

Duck of all widths, also tents, all standard sizes and full 10 oz. weight at The Idaho Department Store.

Do you Want City Property?

If so, see H. A. Stroud & Co., we have a fine list. Some good bargains.

**Don't forget that we
write Fire Insurance**

SANITARY PLUMBING

WE carry nothing in stock but the best **PLUMBING**
FIXTURES and **BRASS GOODS**, all guaranteed.
A full line of heating and engine supplies, pipe and
pipe fittings of all kinds and sizes. We have the
best stock of Garden Hose to be had, including
the Red Hercules Hose, which is fully guaranteed.
All kinds of tanks, pitcher and force pumps and
supplies. Sewer connections a specialty. Be
sure and see our line before purchasing else-
where or closing contracts for plumbing or heating.
Job work given prompt attention and all work
guaranteed. Estimates cheerfully furnished at
any time. Tin Shop in connection.

BERRY & SWANK
Phone 107 12th Avenue

Choice Residence Lots in the New Senior Addition

JUST OPENED FOR SALE
LARGE LOTS, 77 x 190 ft.

**EASY TERMS
PRICES RIGHT**

HILL & TAYLOR Real Estate, Insurance,
Rentals. Phone 52.

PALACE BAR

Fine Wines, Liquors and Cigars.
A Meeting Place for the Boys.
MIXED DRINKS A SPECIALTY

L. S. PRATT, Prop.

TWIN FALLS CREAMERY

JACOBSEN & HOOPS, Props.

Anyone desiring milk cans or separators can secure them
of us at wholesale prices.

Cream gathered from Kimberly and vicinity on Monday and
Thursday; from Filer and vicinity on Tuesday and Friday; from
Twin Falls and vicinity on Wednesday and Saturday.

Shoshone Ave.

Near Depot.

R. A. CARTER

J. N. CLAAR

CARTER & CLAAR

Irrigated Fruit and Farm Lands. Hay and Stock Ranches.
Acreage and City Property

Office on Main St., Fourth door
west of postoffice Phone 105 TWIN FALLS, IDAHO.

Hundreds of Land Buyers

Will Visit

Twin Falls in the Next Thirty Days. If You
Wish to Sell Your Farm or City
Property, See

S. T. Hamilton & Co.

Twin Falls Investment Co.

LIMITED

Sole Agents for Water Rights for all Carey Act
Lands under the

GREAT TWIN FALLS CANAL SYSTEM

8,000 Acres of
Carey Act Land

Still open for original entry under this Canal
System

Land, 50 cents per acre. Perpetual water rights, \$25 per acre, ten
annual payments.

Vehicles from Buhl furnished free to those who desire to inspect
land. Prospective entrymen accompanied by competent locators.

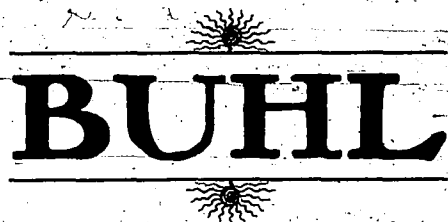

Buhl, located 17 miles west of the city of Twin Falls, is the
leading city on the west end of the tract and the distributing point
for a large area, including the stock districts of Three Creek, Butte
and Roseworth, likewise the farming and fruit growing districts of
Hagerman, Kanoka Flat and Salmon. The railway track is now
completed between Twin Falls and Buhl, and train service has be-
gun. Buhl has a splendid gravity system of waterworks, with a
pressure of 100 pounds in the business section. It will soon be
supplied with electric power and light. Business property values
in Twin Falls have increased 500 per cent in less than two years.
The same opportunities for investment are presented at Buhl. Now
is the time to buy. Write for literature and further information.
Address all communications to

Secretary, Twin Falls Investment Co., Ltd.

TWIN FALLS, IDAHO

Was Content to Return to Idaho.

(Continued from Page 3.)

ed on humanitarian principles, allow-
ing the prisoners work benches with
tools, and here they make fine articles
of the Mexican onyx, and others make
dog collars, bridges, and other bits
and several pretty things out of horse
hair. The prisoners sell these articles
to visitors and have the money to
help their families. The convicted are
mostly Mexicans. I did not see one Jew,
who seemed decidedly imprisoned.
Yuma is situated on the banks of the
silvery Colorado river, which line
is called the "Wall of America,"
because of its spring floods. The gov-
ernment's plan is to store and utilize
all surplus Colorado river water and
distribute it where it is needed.
Within 10 miles north-west of
Yuma, furnishes two irrigating canals,
one on the Arizona side and one on the
California side. These canals
will open to irrigate 100,000 acres,
described fertile growing palms,
olives, oranges, apricots, grapes and
all sub-tropical products. These won-
derful irrigation projects will be the
means of creating a score of arid
lands into a perfect paradise.

Enterprising El Paso.
On January 27th, at 10 p. m., I left
Mr. Burlington at Yuma and boarded
the train for my long journey east
to Asbury Park, N. J. On this tour-
ists' train, there was a personal con-
ductor furnished, to call out points
of interest. Our first stop was at El
Paso, Texas. This is a most beau-
tiful, modern city. The streets were
brilliantly illuminated with colored
lights, in harmony with the Mexican
tapestries, not to please tourists, but a
permanent custom. The conductor
the train improved this opportunity
of getting a good square meal, after
which our conductor piloted us to
many beautiful stores where the Mex-
ican, and Spanish, can be bought for a
song. After purchasing souvenirs we
all returned to the train.

Some distance further we came up
the second largest trestle work
bridge in the world, over the Pecos
river, 320 feet high or 110 feet high-
er than Shoshone falls. An orange
was dropped to the water, and nearly
lost sight of before it reached the
river. The trestle work is 2070 feet
long. From here we traveled over
miles and miles of sagebrush (you all
know what that is) until San Antonio
was sighted. San Antonio is a very
wealthy city, displayed in many ways;
fine residences, modern skyscraper
buildings and most up-to-date depart-
ment stores. But I want to be
proud of is the delightful climate,
bracing to the sick and well alike.
Here we saw an old fortified mission
building, also went through a hall
with a collection of the most beau-
tiful horns that were ever polished and
mounted, from deer, elk, buffalo,
moose and Texas steers. We saw a
pair of elk horns measuring 15 feet
that money could not buy. This is
the most complete collection in Amer-
ica. An eagle was made from the rat-
tles of rattlesnakes.

One day's ride took us across the
state of Louisiana through a low, marshy
country, but where many beauti-
ful trees, ferns and palms, such as
receive the most careful attention in
the houses of the northern states
can be seen growing wild in the woods
in great abundance. Just before reach-
ing New Orleans, we were ferried
across the Mississippi. Unfortunately,
a freight train was just ahead of us,
which caused us to be one hour
late, and we were only favored in
seeing the gorgeous river with its
brilliantly lighted, many very high build-
ings. We took with us no particularly
choice remembrance of this noted city
of the south. We then traveled from
New Orleans several hundred miles
along the coast of the Gulf of Mexico,
then on through North and South
Carolina and Alabama through vari-
ous kinds of country, mostly low
marshy, with apparently little culti-
vation, yet there were many cotton
fields, with "pumpkin colored coons",
in the foreground.

Historical Atlanta.
We arrived at Atlanta, Ga. on time,
allowing us one hour for sight-
seeing. Atlanta is a renowned his-
torical point of the civil war where
Sherman's march with his troops to
the sea. This brought about the song,
"Marching through Georgia." We
visited the old exposition grounds,
viewed the interior of the court house,
also the Carnegie public library, vast
plain but full of fine books, and the
comforts of reading parlors which is
a blessing to any place and I'll more
reading rooms or less elaborate plans,
were accessible even in smaller places,
I am sure there would be less time
for wickedness. After buying a few
cut flowers, which are extremely rea-
sonable in these southern cities, we
boarded the train once more, this
time for Washington, D. C.,
where we arrived at 10:30 p. m. on a
bleak cold night, quite penetrating
weather compared with Sunny Cal-
ifornia. Arriving at this late hour, and
soon to depart, I was unable to see
much of Washington. However, a few
of our crowd, who were en route for
Maine, and myself, strolled along to
the capitol building, and mounted the
beautiful steps. In a few minutes
the pleasing wind drove us back to
the depot. One could spend much
time in Washington to good advan-
tage. The Smithsonian institute, the
congressional library and many places
of interest could be visited. We cross-
ed the beautiful Potomac river just
south of the city. I boarded a train
on the Pennsylvania line at 11:30 p.
m., changed at Trenton, N. J., and
arrived at Asbury Park at noon the fol-
lowing day.

Great Summer Resort.
Asbury Park is situated on the Jer-
sey shore 54 miles from New York
city. It is one of the most popular,
cleanest and most resorts along the
Atlantic coast. The population in
summer is about 100,000, while in win-
ter it is nearer 9000. Its many ways
of entertaining the guests are strict-
ly first-class. At one of the largest
pavilions, Arthur Pryor's band of
New York is hired for the small sum
of \$15,000 for the season. Fine board-

walks afford the people much pleasure
in viewing the ocean and the hundreds
of bathers. At Ocean Grove, just
across Westly lake, the Methodist
great camp meeting grounds, is an
auditorium which seats 12,000 people.
A new pipe organ is just being placed
in this hall, at a cost of \$100,000, sup-
posed to be the finest in the world.
The very finest talent is engaged to
appear in the auditorium during the
summer, from to go and
listen. A chorus of 600 voices
singing, "The Song of the Sea,"
amusement, is elevating to the music
lover-or, I should say, to anyone. It
was my pleasure and privilege to take
several trips to New York. My neph-
ew, who is about one day. We first
visited Grant's tomb, a very beau-
tiful structure of granite, wherein the
bodies of Gen. Grant and his wife are
resting. This tomb is on the bank of
the Hudson. We took a car on the
subway and went to the Brooklyn
bridge, then over this bridge on the
elevated to Brooklyn, soon returning
by subway to the East river, then
up in the air 41 stories in the Singer
building. They say the Brooklyn
bridge is suspended, the Singer build-
ing has gone up, and the subway is
in a hole. This is a positive fact.
The Merry Widow, attractions at the
Hippodrome, E. H. Southern in a new
popular play, and many of such at-
tractions, which would tempt me to
Falls people, were being played in
New York. After two months' visit
with my dear old mother, who has
since passed away, I returned to Ida-
ho.

Homeward Bound.

From Asbury Park I went on the B.
& O. to Chicago, passing through
Philadelphia, Pittsburg, Baltimore,
and John. Here we began climbing the
Cumberland mountains, not quite so
high as the Rockies but more pic-
turesque. The country through Penn-
sylvania and Ohio is all or mostly
fine. Most beautiful farm homes and
orchards can be seen with a great
variety of landscape. The highest
point we reached on the Cumberland
mountains was Sandeasch, elevation
1600 feet. This portion of my trip
was very pretty.

On arriving in Chicago, on Sunday
morning, where my home was for
about eight years, I began to feel as
one who had returned home, after
being gone for some time. My friends
had planned pleasure for me for every
minute of my brief visit. I was
in right and went to hear Gussie
speak at the auditorium. He is just
as grand as ever. On Monday after-
noon my friend, who is a member of
the Chicago Culture club, had secured
a visitor's ticket previous to my
coming so I had the pleasure and
honor of being present, and an-
nounced as a visitor from Kimberly
Idaho. This club has a membership of
400 ladies. One of the prettiest fea-
tures on the program was "Babes in
Toyland", a most interesting number
also the soprano, a recitation by
Ophelia Blair (her own composition).
She is a modern writer and fast-
becoming famous. The Comic Opera
"Robin Hood" was very delightfully
produced at the Auditorium. Of course
we had to see the "Merry Widow" and
"The Man from Home". These were
all very fine, and a rare treat to a
resident of Twin Falls.

A shopping tour, and a lunch at
Marshall Field's were of course in
line, and a hunt for bargains, such as
can only be found in Chicago, were
made interesting and profitable.
One week later I boarded the Over-
land limited, for Minidoka, stopping
one day in Omaha, a fine city on
the banks of the Mississippi.
Leaving Omaha at 4:30 p. m. on Tues-
day for a day's ride over the great
American desert to reach, once more,
the land of our birth, Idaho.
"Kind Providence our lot has cast,
And yet we have to choose our lot
at last."

"If you're inquiring where to go,
"Come down to southern Idaho."

Dick Low Wheat.
Milroy Perrine Lumber Co., Ltd. of
Buhl, Idaho, still have a limited amount
on hand.

Blahee will go anywhere at any time
and take out door photos for you.

For fine views and postcards go to
Blahee.

FOR SALE—Second-hand Remington
typewriter, in first class condi-
tion.

Twin Falls Title & Abstract Co.
Over First National Bank.

FOR RENT—A ranch, one and a
quarter miles from Buhl, 70 acres
cleared, 30 acres plowed, two-room
plastered house, and barn on easy
terms. Apply to F. S. Marshall, Buhl,
Idaho.

FOR SALE—A two gang 12 in.
Syracuse plow. It has been used but
one season plowing about 120 acres.
A No. 1 team of mares weight about
2500 pounds, six and eight years old.
Write or come to see.

J. E. Steinhour, Murtaugh, Ida.

Choice Seed Potatoes.
Burbank choice seed potatoes for
sale, 80c per hundred. See samples
and leave orders at Palace Meat Mar-
ket.

For out door photos of any kind see
Blahee.

OREGON SHORT LINE.

Excursions to Wallace, Idaho, May
9th and 10th.

For state Republican convention.
One fare for the round trip to Hunt-
ington plus \$12.50 beyond. Tickets
limited to May 20th. Special train
will be operated from Pocatello to
Wallace, schedule of which will be an-
nounced through agents later.

D. E. BURLY, G. P. & T. A., Salt
Lake.

D. E. SULLIVAN, Agent, Twin Falls,
May 13

Tents 8 x 10; 10 x 12; 12 x 14; 12
x 16 now on sale at The Idaho Depart-
ment Store.

Everything in legal blanks at The
News office.

H. A. STROUD & CO.

Exclusive Real Estate and Investments.

Office in St. Regis Block
Shoshone avenue, Ground Floor
We always have customers for land at its
present value.

H. A. STROUD & CO.

Who do as they advertise.

Abstracts of Title

FIRE INSURANCE

Twin Falls Title & Abstract Co.

OVER FIRST NATIONAL BANK.

PHONE 168.

The Largest Fire Insurance Agency in
Southern Idaho.

The Electric Mills

KIMBERLY, IDAHO

Will Pay or Contract the Highest Market Price for Wheat, Oats or
Barley. Call, write or telephone us.

THE T. & K. MILLING CO.

W. H. THO MAS, Manager.

Everybody Works but Father

He does nothing but run the bar at the Hotel
Perrine, Twin Falls. Only the choicest brands of
Wines, Liquors and Cigars

H. C. Sorenson & Co.

Hotel Perrine

RIGHT UP TO DATE

Steam Heat

Electric Lights

Sample Rooms.

E. B. WILLIAMS, PROPRIETOR.

Twin Falls,

Idaho.

SEE

J. K. MARTIN

before building your cisterns or having foundation
work laid. All work guaranteed and promptly at-
tended to. Address Twin Falls, Idaho or leave or-
ders at J. V. Marshall Real Estate office.

The Mission Cafe

The Best Restaurant in the City.
Everything New. Service Excellent.
Short Orders a Specialty.

: : : Opposite Postoffice : : :

NOTICE OF OPENING OF CAREY ACT LANDS

Boise, Idaho, April 23, 1908.

By order of the state board of land commissioners of the state of Idaho, the following described desert lands will be open for entry and settlement on and after May 11, 1908, and March 3, 1909, commonly known as the Carey acts, and an act of the legislature of Idaho, approved March 2, 1895, and the rules and regulations of the state board of land commissioners of Idaho in relation thereto: All that portion of the lands described in the contract between the United States and the state of Idaho, being section 1, lot 1, and 2, which are situated in Twin Falls county, state of Idaho, and are more particularly described in said contract, which is on file with the state board of land commissioners as follows:

| DESCRIPTION | ACRES |
|-----------------------------|--------|
| Township 11 S., range 14 E. | |
| Sec. 12, S 1/4 | 320 |
| Sec. 13, all | 638.28 |
| Sec. 24, all | 640 |
| Sec. 25, all | 640 |
| Township 11 S., range 15 E. | |
| Sec. 1, all | 638.28 |
| Sec. 2, all | 638.28 |
| Sec. 3, all | 638.48 |
| Sec. 4, all | 640 |
| Sec. 5, S 1/4 | 320 |
| Sec. 7, lots 3 and 4 | 75.69 |
| Sec. 7, E 1/4 of NW 1/4 | 80 |
| Sec. 7, S 1/4 | 80 |
| Sec. 7, E 1/4 | 320 |
| Sec. 9, all | 640 |
| Sec. 10, all | 640 |
| Sec. 11, all | 640 |
| Sec. 12, all | 640 |
| Sec. 13, all | 640 |
| Sec. 14, N 1/4 | 320 |
| Sec. 15, all | 640 |
| Sec. 16, all | 640 |
| Sec. 18, all | 631.80 |
| Sec. 19, all | 632.08 |
| Sec. 20, all | 640 |
| Sec. 21, all | 639.08 |
| Sec. 22, W 1/4 of NW 1/4 | 80 |
| Sec. 22, NE 1/4 of SW 1/4 | 40 |
| Sec. 27, W 1/4 of NW 1/4 | 80 |
| Sec. 27, E 1/4 of NW 1/4 | 80 |
| Sec. 28, all of SW 1/4 | 640 |
| Sec. 29, all | 640 |
| Sec. 30, all | 632.40 |
| Sec. 31, all | 633.04 |
| Sec. 32, all | 640 |
| Sec. 33, N 1/4 | 320 |
| Sec. 33, N 1/2 of SW 1/4 | 80 |
| Sec. 33, N 1/2 of SE 1/4 | 80 |
| Sec. 34, W 1/4 of SW 1/4 | 80 |
| Sec. 34, NW 1/4 of SW 1/4 | 40 |
| Township 11 S., range 18 E. | |
| Sec. 2, S 1/4 | 320 |
| Sec. 3, SW 1/4 of NW 1/4 | 40 |
| Sec. 3, all | 639.64 |
| Sec. 5, all | 639.62 |
| Sec. 7, all | 639.40 |
| Sec. 7, all | 634.62 |
| Sec. 8, all | 640 |
| Sec. 9, all | 640 |
| Sec. 10, W 1/4 | 320 |
| Sec. 10, SW 1/4 of NE 1/4 | 160 |
| Sec. 10, W 1/4 of SE 1/4 | 40 |
| Sec. 10, NE 1/4 of NE 1/4 | 40 |
| Sec. 11, NW 1/4 | 320 |
| Sec. 11, N 1/2 of SW 1/4 | 80 |
| Sec. 11, SE 1/4 of SW 1/4 | 40 |
| Sec. 12, W 1/4 | 320 |
| Sec. 12, SE 1/4 | 160 |
| Sec. 12, S 1/4 of NE 1/4 | 40 |
| Sec. 13, all | 640 |
| Sec. 14, E 1/4 | 320 |
| Sec. 14, SW 1/4 | 160 |
| Sec. 15, all | 640 |
| Sec. 17, all | 640 |
| Sec. 18, all | 635.80 |
| Sec. 19, E 1/4 | 320 |
| Sec. 19, E 1/4 of NW 1/4 | 80 |
| Sec. 19, lot 1 and 2 | 73.31 |
| Sec. 20, all | 640 |
| Sec. 21, all | 640 |
| Sec. 22, all | 640 |
| Sec. 23, all | 640 |
| Sec. 24, all | 640 |
| Sec. 25, all | 640 |
| Sec. 26, all | 640 |
| Sec. 27, all | 640 |
| Sec. 28, all | 640 |
| Sec. 29, all | 640 |
| Sec. 30, all | 640 |
| Sec. 31, all | 640 |
| Sec. 34, all of NW 1/4 | 640 |
| Township 11 S., range 17 E. | |
| Sec. 7, lot 2 | 17.39 |
| Sec. 7, lot 3 | 17.74 |
| Sec. 7, lot 4 | 17.49 |
| Sec. 7, SE 1/4 of NW 1/4 | 40 |
| Sec. 7, S 1/4 of NE 1/4 | 80 |
| Sec. 7, E 1/4 of SW 1/4 | 80 |
| Sec. 7, SE 1/4 | 160 |
| Sec. 8, S 1/4 | 320 |
| Sec. 8, S 1/4 of NW 1/4 | 80 |
| Sec. 8, SW 1/4 of NE 1/4 | 80 |
| Sec. 9, SW 1/4 of NW 1/4 | 40 |
| Sec. 9, S 1/4 of SE 1/4 | 160 |
| Sec. 9, S 1/4 of SW 1/4 | 80 |
| Sec. 9, NW 1/4 of SE 1/4 | 40 |
| Sec. 17, all | 640 |
| Sec. 18, all | 655.44 |
| Sec. 19, lot 1 | 17.25 |
| Sec. 19, lot 2 | 19.73 |
| Sec. 19, lot 3 | 19.91 |
| Sec. 19, lot 4 | 20.09 |
| Sec. 19, NE 1/4 | 160 |
| Sec. 19, E 1/4 of NW 1/4 | 80 |
| Sec. 19, E 1/4 of SW 1/4 | 80 |
| Sec. 19, N 1/2 of SE 1/4 | 80 |
| Sec. 20, N 1/4 | 320 |
| Sec. 20, S 1/4 | 160 |
| Sec. 20, N 1/2 of SW 1/4 | 80 |
| Sec. 21, all | 640 |
| Sec. 22, all | 640 |
| Sec. 23, all | 640 |
| Sec. 24, all | 640 |
| Sec. 27, all | 640 |
| Sec. 28, NE 1/4 | 160 |
| Sec. 28, N 1/2 of NW 1/4 | 80 |
| Sec. 34, all | 640 |
| Sec. 35, all | 640 |
| Township 12 S., range 15 E. | |
| Sec. 3, W 1/4 of SW 1/4 | 80 |
| Sec. 10, W 1/4 | 320 |
| Sec. 10, W 1/2 of NE 1/4 | 80 |
| Sec. 10, W 1/2 of SE 1/4 | 80 |
| Sec. 12, all | 640 |

BUHL - BACHELORS - NERVOUS

Continued from Page 1.

He will soon open a general merchandise establishment here.

F. P. Conroy, of Pocatello, was in the city Friday on business.

T. E. Morgan of Salt Lake City was a guest of Hotel Buhl last week.

W. E. Hunter of La Grange, Ill., was among the strangers looking for land on this end of the tract Monday.

M. C. Ware of Seattle, Wash., registered at Hotel Buhl Tuesday.

H. H. Runyon, and L. P. Runyon came up from Dunkirk Monday on business.

L. W. Collins of Chicago, spent several days in Buhl the past part of the week looking around for a piece of land to suit him.

John Lowrie and John Severier of Portland, Oregon, were in Buhl Tuesday investigating the opportunities for investments on this end of the tract.

C. H. Keyes and H. H. Fisher were in town for a short time today.

C. D. Scott of Dubuque, Iowa, is in town looking after his interests here.

Mr. Scott owns considerable town property in Buhl.

J. O. Milner came up from Twin Falls today to see how his pigs are doing, and found them doing fine.

Mr. Milner has a fine ranch adjoining the town in the north. He has several acres in orchard which will bear next year.

F. L. Roberts of Shoshone, Wyo., was among the investment seekers in Buhl yesterday.

If something is not done soon to abate the matrimonial fever in Buhl, even the most loyal supporters of the Bachelors club will be bound to admit that the club will have a strenuous time to maintain its existence.

There is no telling who will be the next victim of bright eyes and bewitching smiles. The club would fare better if there were not so many pretty girls around.

J. Warren White moved into P. W. Monahan's dwelling house on Ninth avenue Tuesday.

Dr. James Monroe moved into the dwelling house in the rear of his office on Broadway yesterday.

Mrs. F. P. Marshall entertained very delightfully Friday afternoon with a miscellaneous shower in honor of Miss Xenia Farlow whose marriage to Homer Evans occurred Sunday.

The house was beautifully decorated with hearts and potted plants. The table in the dining room, where the gifts of the shower were displayed as Miss Farlow opened them, being especially pretty.

Hearts, with pencils attached were passed to each guest upon which they were asked to write a toast to the bride.

Mrs. W. J. Harger, George Marshall, Albin Nihart, George Eveleth, J. War-

ren White, E. A. Wyatt, E. A. Littler, G. A. Farlow, Frank Eveleth, C. H. Taylor, Tom Holmes, M. D. L. Barstow and Dr. Jane Shank; Misses Xenia Farlow, Bartholomew, Hincley, Day Shank and Nan Vance. Mrs. Farlow was assisted by Misses Laura Griffith and Hazel Allred.

Miss Laura Bartholomew, who had been the guest of Mrs. George Eveleth for several weeks, returned to Blue Lakes Monday.

A very quiet home wedding occurred at the home of M. and Mrs. G. A. Farlow on Sunday afternoon, when Xenia Farlow and Homer B. Evans were united in marriage.

Dr. Barnes of Boise officiating. A very few friends and intimate friends were present. After the ceremony and an informal dinner, the company was taken by surprise, as were all their friends afterwards by two of the guests asking also to be united in marriage bonds.

The proper papers being produced the genial clergyman again took the place, and Clarence Provins and Miss Edith Milner were solemnly pronounced man and wife.

The young people had stolen a march on their friends, who were not expecting the happy event until June.

Mr. and Mrs. Evans will reside in Buhl, where they will be at home to their friends in a few days.

Mr. and Mrs. Provins will live on their ranch, but for a few weeks Mrs. Provins will continue to make her home with her father, E. A. Milner.

James H. Shields of Twin Falls spent Sunday with his parents on the Burley ranch.

Mr. Robert M. Hayes was a Twin Falls visitor Saturday.

Miss Eva Albee, who has been visiting her uncle and aunt, Dr. and Mrs. D. P. Albee, returned last week to her home in Eureka, California.

Miss Albee, during her stay in Buhl, made many friends who regret very much her departure.

Mrs. J. W. Faris is the guest of her sister, Mrs. Leah Burnside, in Shoshone.

Mrs. E. A. Wyatt and Miss Hincley entertained Wednesday evening with a shower for Mrs. Clarence Provins.

A surprise party on Glen Taylor Friday evening proved to be a surprise on the crowd of young people, as the young man had found it out and had retired when they reached his home.

However, he was induced to appear. Games were played until half past 11, when an elaborate luncheon was served.

Those present were: Hazel Allred, Cora Scholer, Ruth Stradley, Glen Taylor, Dave Howard, Howard, Louis Taylor, Retta Shank, Lillie Lindstrom, Eva Smith, Addie and Easter Howards, Kenneth Shank, Clarence Davis, Lucien Shields, Sam Stradley, Glen Taylor, Dave Howard, Ray Weaver, Lester Russell, Wayne Russell and Leon Taylor.

Dr. and Mrs. D. P. Albee and Master Joe spent Friday in Twin Falls, the guest of Mrs. Albee's father, Judge Hanson.

Mrs. J. Warren White entertained the Union Ladies Aid society Saturday afternoon. Delightful refreshments were served during the social hour.

Mrs. F. S. Marshall was the hostess of the St. Elizabeth Guild, held in the parlors of Hotel Buhl Thursday afternoon. After an interesting business session, refreshments were served.

Notice for Publication—Final Proof. I, Harry B. Lewis, of Twin Falls, Idaho, who made entry No. 2027, under the provisions of an act of the legislature of the state of Idaho, commonly known as the "Caray act," approved March 2nd, 1893, which embraces the SE 1/4 of SW 1/4 of section 13 and NW 1/4 of NE 1/4 and E 1/2 of NW 1/4 of section 24, township 3 S., range 12 E., do hereby give notice of my intention to make final proof to establish my claim to the land above described, and that I expect to prove that I have resided on, reclaimed and cultivated said land as required by law, before E. B. Williams, at Twin Falls, Idaho, on the 8th day of June, 1908, by two of the following witnesses: Everett M. Sweezy, Alva A. Slocumb, Albert N. Ring and Marlin J. Sweezy, all of Twin Falls, Idaho.

HARRY B. LEWIS, Entryman.

The Don Bryan Realty Co. will locate you on Salmon river land and guarantee satisfaction for 50 cents per acre.

Dr. F. F. McAttee dentist office with Dr. T. O. Boyd, over Sprague's drug store.

See the Don Bryan Realty Co. for bargains.

Join the Merry Crowd

At the Majestic Fountain and have one of their delicious Sundaes with crushed fruits.

We have a special Soda Menu, giving you a choice of over 50 cooling, refreshing, summer drinks. If you want to be in it you must join the crowd at the Majestic Fountain

Majestic Pharmacy

OPPOSITE HOTEL REARINE

FELL DEAD

THAT is what we thought had happened to a gentleman when he saw our immense line of light weight

SUMMER SHIRTS

We have all of the pretty patterns; just in from the New York markets. We have more Fancy Shirts for men than any Twin Falls store. We specialize in things for men.

O. A. STALKER

"THE HUB" NEXT DOOR TO HARDER'S GROCERY

C. E. EVANS & CO.

Successors to Woods, Evans & Thomas.

REAL ESTATE, RENTALS, COLLECTIONS and INSURANCE

ACREAGE And CITY PROPERTY

You Will Find Us at the Same Old Stand.

The Idaho Department Store

The Great White Sale and Sale of Mill Ends has gone far beyond our fondest expectations, showing that the people of Twin Falls and vicinity appreciate our efforts at making a REAL SALE. The people will soon know that when we say SALE, we have something to offer that is attractive in QUALITY and PRICE. "WATCH US" is the word. Watch for our advertising, we will always have something to interest the buying public. Last Saturday prices are good tomorrow, SATURDAY the 9th.

EXTRA SPECIAL

JUST RECEIVED AND PLACED ON SALE—200 cases of the celebrated ROYAL CLUB BRAND of canned goods. These canned goods stand second to none. We are ready and willing to cut this brand with anything the market affords. It is the HIGHEST GRADE POSSIBLE to PUT INTO CANS, and every can is GUARANTEED. If you are not satisfied with your canned goods, try a can of ROYAL CLUB and you will have no more trouble. No matter what you want, we have it. Raspberries, Blackberries, Strawberries, Peaches, Corn, Tomatoes, Peas Apricots, Corn on cob, Sweet Potatoes, Custard Pumpkin, Asparagus tips, in fact we have everything put up in ROYAL CLUB canned goods. ARMOUR STAR HAMS and BACON the HIGHEST GRADE OF MEAT CURED, ALWAYS in STOCK.

| | |
|--|---|
| <p>Look to Us for Your Dress Up Clothes</p> <p>MEN'S AND YOUNG MEN'S</p> <p>No store in the state of Idaho shows a larger stock of SMART STYLES in all grades of Clothing.</p> | <p>Shoes—200 Pairs of Samples Now In</p> <p>All the new Tans and Browns, now so popular.</p> <p>Surveyors' boots and corduroy pants, the best made, always at the right price.</p> |
|--|---|

IDAHO DEPARTMENT STORE

The Only Department Store on the Tract.

SPECIAL PANTS SALE

20%
Discount

for one week at the
PALACE
CLOTHING
& SHOE CO.

This Will Interest
You

St. Regis Bldg., Twin Falls

SEPARATOR MILK FOR CALVES

Properly Fed It Will Result in Healthy Stock.

The practical and successful feeding of hand-separator skim milk to calves is a subject of farm practice that is worthy of study and consideration. The evolution of the hand-separator has necessitated or brought about the rearing of many calves on hand-separator skim milk, and as the use of the hand-separator is of recent origin, this farm business has developed largely during recent years and bids fair to be one of the most important subjects before the cattle-raiser of the country. If it is not already so, it is safe to assume that nearly half of the calves reared throughout the country are raised on hand-separator skim milk, and this percentage is increasing each year. Therefore, the subject of raising good calves by this method is undeniably a very important one. That there is room for improvement must certainly be admitted, for what man knowing the average method of feeding calves can deny that the common method is rather primitive, and, often cruel. The average man, rearing calves, handles the subject in the following way: He selects two large pails and pours in skim milk until they are as full as they can be carried; he then takes a goat-skin club and, tucking it under his arm, approaches the calf. The hungry calf, knowing that the first come are the first to be served, two calves are allowed to drink at the same time from each bucket, and with the club he beats the other away. After he thinks that a calf has received enough milk, it is forced out of the pail by either a pull on the ear or a hit from the club, and another calf is allowed his turn. The calf having finished his allowed portion, resorts to his favorite pastime of sucking and butting. Thus are the calves fed, and thus starts the famous chain gang. If there are but two, they double up, but wherever there are many, they form a continuous chain.

Now this is not the best way to feed calves, because a man can feed them wisely or, to the best advantage to himself or the calves. Some calves drink faster than others. They are taught to bolt their food, and it is allowed to suck, will fill themselves with air and often, cause bloating. Besides, this is a very dangerous

method of spreading disease among the calves. Such ailments as contagious scours, calf cholera, etc., are spread in this way. The calf stanchion is the best equipment for calf feeding. This stanchion should be supplied with a little box or manger and the stanchion should be used both in the calf pen and in the calf pasture. Care should be used to feed the skim milk fresh and warm from the separator, giving small rations in preference to large ones. With the present prices paid for butter fat, it requires a rich man to afford his calves the luxury of nursing their dams, and the man who saves his cannot afford the time to milk and feed his calves in either getting a very large salary or is well enough off so that he need not economize in this way.

This does not, of course, refer to the man raising purebred beef cattle, or the range conditions. There is quite a diversity of opinion in the method of rearing a calf on skim milk, and I do not presume that mine is the only one or that it is particularly better than others. But I have been very successful in raising calves for the last 20 years, and attribute this success largely to the method employed.

After the calf is born, I believe it is a good plan to allow it to remain with its dam for a day or two. It may get the first milk, which is very rich in albumin and ash—food substances which are needed by the young calf. There is another advantage in this method, and that is the calf will aid in removing the milk from the udder and will benefit the cow in keeping her quiet during a time when she needs rest.

After the calf is removed from the cow, it should be given its mother's milk for a few days, and then any whole milk will answer, but it is better to give milk that is low in percent of butter fat than that which is high. Feed small rations in clean pails. When the calf is from 10 days to two weeks old, it may be changed from whole milk to skim milk by adding a small amount of skim milk, say one-fourth, and increasing this percent at each feeding until the change is made and the calf is on a skim milk ration. The skim milk to be the best for calves should be fresh and warm from the separator. Now is the time to start feeding a butter-fat substitute, and this may be given in the milk until the calf is able to eat ground feed. Oil meal makes a good calf feed, and a little added to the

skim milk will answer the purpose. Here is when the calf stanchion will come handy, for with such an equipment the calf can be taught to eat much earlier on account of it being held in front of the grain and it being free from the annoyance of the other calves.

A good calf feed may be made by mixing the following stuffs: Blood meal, 10 pounds; bone meal, 5 pounds; oil meal, 20 pounds; oat meal, 20 pounds; corn meal, 20 pounds. This mixed well together and given in small rations after the skim milk has been fed. The calf should also have free access to water as well as well as hay or pasture, as the season may require. The grain may be changed to simply corn and oats, or bran, as the calf grows older, say after three months old. In this way good calves may be raised in an economic way, and the valuable butter fat will be saved.

Don't count that skim milk is thin any no good, but feed it with the knowledge that it has in it the necessary food elements to grow the calf, and a small ration is safer to feed than a large one. Give the calf milk for seven or eight months, and if you have plenty a longer time will make a better calf. Don't say good calves can't be grown on skim milk, for this is not true, and thousands can show you tens of thousands of fine skim milk calves. You may say, "I can't" or "Bill Jones can't," but you have a chance to learn, and it certainly pays to know how.

Give the cow's baby a chance and treat it kindly and it will more than pay you.—Pacific Farmer.

Cure Your Kidneys

Do Not Endanger Life When a Twin Falls Citizen Shows You the Cure.

Why will people continue to suffer the agonies of kidney complaint, backache, urinary disorders, lameness, headaches, languor, why allow themselves to become chronic invalids, when a certain cure is offered them?

Doan's Kidney Pills is the remedy to use, because it gives to the kidneys the help they need to perform their work.

If you have any, even one, of the symptoms of kidney diseases, cure yourself now, before diabetes, dropsy or Bright's disease sets in. Read this Twin Falls testimony.

E. R. Chandler, farmer, living one mile and a half south of Twin Falls, Idaho, says: "I do not hesitate to recommend Doan's Kidney Pills for they proved of great benefit to me. For two or three years I suffered off and on with kidney complaint and backache and on one occasion I was laid up for a week on account of it."

I procured a box of Doan's Kidney Pills at Sprague's drug store. I took this remedy faithfully and found it to be just as represented. Doan's Kidney Pills relieved the pains in my back in a very short time. I know this remedy to be safe and reliable for kidney trouble, and should I have a return of the trouble I will again resort to Doan's Kidney Pills."

For sale by all dealers. Price 50 cents.

Wester-Milburn Co., Buffalo, New York, sole agents for United States. Remember the name—Doan's—and take no other.

FOR SALE—90 acres near Hagerman. First class water right, good buildings, orchard, etc. This is one of the best farms in the valley. For particulars address: E. H. BURDY, Hagerman, Idaho.

FOR SALE—Pure bred, healthy, acclimated Poland China hogs. Can be seen where they were bred, one mile north of town. G. D. Alken, Twin Falls.

It is wise for the Twin Falls farmers to buy their trees from the Twin Falls Nursery and avoid danger and delay in shipment and risk of trees not being acclimated. I grow my own trees and I am not a tree broker. JAMES A. WATERS, P. O. Box 634, Telephone 1A, Twin Falls.

If you are looking for tents or canvas see The Idaho Department Store. All sizes in stock.

Ground feed, garden seeds, mixed grass seed for permanent pasture. Twin Falls Grain & Produce Co.

"The Twin Falls Country"

80,000 Acres Carey Act
Lands Open for Entry Under

THE TWIN FALLS- SALMON RIVER PROJECT

At Twin Falls, Idaho

June 1st, 1908

Registration books open May 25, '08
Registration books close May 31, '08
Drawing takes place June 1, '08

For booklet giving full information write
R. M. McCOLLUM, Secretary

Twin Falls Investment Co., Ltd.
TWIN FALLS, IDAHO

Sole agents for sale of land and water rights

Carey Act Lands can be located by power of attorney. Blanks furnished on Application

A \$400 Corner Lot Given Away by the Farmers Real Estate & Livestock Co.

Watch This Space For Full Particulars Next Week

We are now cruising thoroughly the Salmon River Project of 80,000 acres and when we get through cruising we will be in a position to assist our many friends and the strangers that will be with us to get the very best possible land locations. We can assure our customers that we will not locate anyone on land that will not be as we represent it or that we wouldn't want ourselves.

Our list of improved and unimproved ranches on the Twin Falls tract is the very best. If you want to wear diamonds and get the best that is to be had you cannot afford to miss the opportunity of getting C. A. McMaster of the Farmers Real Estate Company, and a Pioneer Farmer on this tract, to guide you to the most desirable land under the Twin Falls system.

WE GUARANTEE YOU SATISFACTION OR NO PAY.

Yours for legitimate business,

White & McMaster

Offices in the Postoffice Building.

Twin Falls, Idaho.

IRRIGATED LANDS CO., LTD.

Twin Falls, Idaho. Office, North Wing, Hotel Perrine.

We have carefully cruised the entire Salmon segregation and are prepared to locate settlers on choice lands, either by power of attorney, or in person, for a reasonable fee.

A. McPherson

George F. Sprague

TWIN FALLS, IDAHO.

E. J. OSTRANDER
President

E. G. REED
Sec. Treas.

Ostrander-Reed Lbr. Co., Ltd.
All Kinds of Building Material

YARDS: JEROME
WENDELL

Jerome, Ida.

GEORGE R. DUNN

J. M. SHANK

DUNN & SHANK

Real Estate
Farm and City Property

BUHL, : : : : IDAHO.

PIANOS AND ORGANS

All Kinds of String Instruments.
Sheet Music

SOLD ON EASY TERMS
TEACHING and REPAIRING.

WESTERN MUSIC CO.
CARLSON & HARRISON.

REAL ESTATE OFFICE OF

Barnett Stillwell, Twin Falls, Idaho.

LANDS BOUGHT AND SOLD. PROPERTY OF NON-RESIDENTS CARED FOR. RENTALS.

Fire Insurance Written.

First Door Southwest of Idaho Department Store.

M. W. DENOYER, Gen. Mgr.

J. H. SEAVER

Motors, Fans, Fixtures and Supplies
Electric Light and Power Wiring

Estimates Furnished

TWIN FALLS ELECTRICAL CO.
TWIN FALLS, IDAHO.

Princess Incubators and Brooders
are sure hatches.

Agents Wanted

PRINCESS INCUBATOR CO.
Idaho Falls, Idaho.

ATTENTION!

Why Not Patronize Home Talent While?
E. W. Motley architect, will draw your plans and superintend your work and have it done right. Practice what you preach and get your plans at home and save the expense of going away from home. Office in Dr. Boyd's Building.

Twin Falls Investment Co.

SOLE AGENT FOR SALE OF CAREY ACT LANDS AND WATER RIGHTS UNDER THE

SALMON RIVER PROJECT

To Be Opened in Twin Falls, June 1, 1908.

NO AGENTS EMPLOYED AND NO COMMISSIONS PAID

FOR INFORMATION ADDRESS

R. M. McCollum, Secretary,
TWIN FALLS, IDAHO.

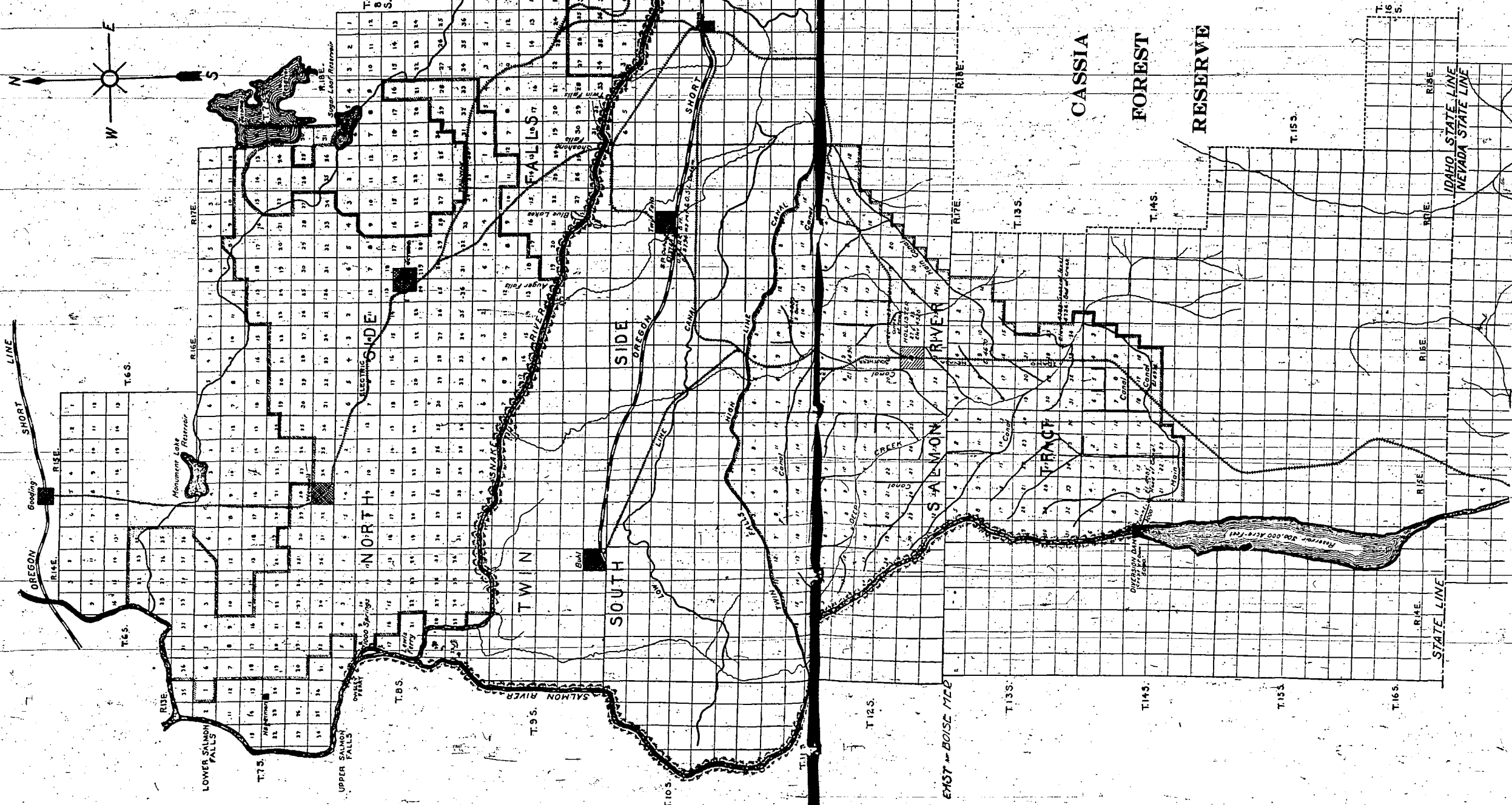

LAND OF OPPORTUNITY

The Twin Falls North and South side canal systems and the Twin Falls Salmon river project cover 570,000 acres of the finest kind of agricultural and horticultural land. The Twin Falls "Bureau" project, which is an extension of the South side or original Twin Falls system, and which is now being projected, will reclaim approximately 600,000 acres more, making over 1,000,000 acres in a compact body, the largest irrigated tract in the world. This acreage will sustain a large population as a 10-acre farm will easily support a family.

The North and South side tracts are watered from the Milner dam, as shown by the map. The Salmon tract will get its water from the Salmon river, a never failing stream with a large drainage area which can never be disturbed, and a water right which is absolutely unassailable as no other land can be irrigated from the Salmon river above the dam site.

Water was turned into the South side canals on March 1, 1905. Approximately 200,000 acres of land has been sold on the South side, which is covered with magnificent farms, beautiful fields and promising

orchards. A branch of the Oregon Short Line which will ultimately form a portion of the main line, traverses the South side tract from east to west. Coulees, or draws, occur frequently and afford the finest kind of drainage besides providing an outlet for waste water, and watercourses for stock water in winter.

Work was commenced on the North side system one year ago and already water is being delivered to 30,000 acres through magnificently constructed canals. The remaining 150,000 acres will be watered next spring. An electric road crosses the North side from Gooding to Milner, touching Wendell, Jerome and Hillsdale. This road is now being constructed and will be in operation to Jerome by the end of the year. Wherever wells have been drilled on the North side an abundant flow of beautiful spring water has been obtained at depths varying from 150 to 350 feet.

On June 1, 1908, in the city of Twin Falls, 50,000 acres of the Salmon tract will be opened for entry. The land will be sold for 50 cents an acre and water rights for \$40 an acre, on which a payment of \$3 per acre is required at time of filing, the remaining payments being distributed over a period of 12 years. Filings can be made either in person or by

power of attorney. Every American citizen, and every one who has declared intention of becoming a citizen, has a Carey act right, regardless of whether they have used their homestead, stone and timber, desert or any other rights. Those who desire to obtain lands make their applications to the Twin Falls Investment Co., sole agents for the sale of land and water rights. Accompanying each application is a certified check covering the first payment on land and water right, which is 25 cents per acre for the land and \$3 per acre for the water right. For a filing on 40 acres, the deposit required to cover the first payment on land, water right, filing fees, notarial and recording fees, is \$131.50; for 80 acres \$262.50; for 120 acres \$393.50; for 160 acres \$524.50. No one person can file upon more than 160 acres. The names of the applicants are registered and numbered and the numbers are stamped on wooden blocks which are placed in a churn or other suitable receptacle. The blocks are thoroughly mixed before they are drawn from the box. The applicant whose number is first drawn from the box has the first choice of land, the second number the second choice and so on until all the numbers are drawn. In the event that an applicant whose

number is drawn does not wish to file, his or her check is promptly refunded without charge. The drawing is conducted under the direct supervision of the state board of land commissioners and is absolutely fair in every particular. The state has an inspector on the works during construction and the state land board passes upon and approves the works before they are turned over to the settlers in a completed state. This transfer is made when a majority of the water rights shall have been sold and the state pronounces the works complete according to contract. Thus the state stands between the settler and the company and protects the former.

The Salmon tract is identical with the South side or original Twin Falls tract, with the exception that it is more level and the soil is deeper and there is less rock. The slope from the foothills is ideal for irrigation and the drainage is perfect. There are well defined and proven water plains under the Salmon tract and the precipitation there is greater than on the South or North side Twin Falls tracts.

V. I. Case 15-horsepower engine and a 32 by 64 Case separator for sale. Both in first class condition. Address Box 422, Twin Falls, Idaho. Up-to-date photos at Blasco's.

The Iris Theatre

COSTELLO BUILDING
Shoshone Avenue.

NOW OPEN

Performances every hour from 7:30 p. m. Entire change of program three times a week. House fully protected by exits, both front and rear.

STOCK MEN

Rock and Stock Salt

AT
Twin Falls
Grain & Produce
Company

Nibley-Channel Lumber Co.

Headquarters for
Lumber, Sash, Doors, Mouldings
Builders' Hardware
Red Devil Portland Cement
Laramie Plaster
Oregon Lime
Paints, Oils, Glass
Murecco Wall Tints
Ruberoid Roofing
Screen Doors
Rock Springs Coal

TELEPHONE 28
Offices and Yards
13th Ave and 10th St.

The Irrigator

The Farm Journal for Farmers on irrigated tracts. Published in the heart of an irrigated district. Indispensable to the successful farmer. Subscribers now and to solve the land problem. Illustrated initial copy for April.
ONE DOLLAR A YEAR.
The Irrigator
Heyburn, Idaho.

Expert Kodak Finishing

Send for price list and sample photo of Twin Falls.

HELM & AMOS

STUDIO, POSTOFFICE BLDG.
TWIN FALLS, IDAHO.

Seeds, Trees, Corn

WILL'S SILVER Anniversary Catalogue OF EVERYTHING FOR FARM, GARDEN AND LAWN. HANDSOME BOOK PRINTED IN FIVE COLORS. All about HARDY ACCLIMATED SEEDS AND TREES.
OSCAR H. WILL & CO.
Bismarck, North Dakota.

WANTED—Contractors and men with teams to work on canal, 112 to 176 per cubic yard paid for handling dirt. \$1.00 per day for man and team. Address Engineering Dept., American Falls Canal & Power Co., Aberdeen, Idaho.

Forty acres of land four miles west of Twin Falls to rent on shares. L. E. Rowell, Twin Falls.

You will make no mistake in listing your property with H. A. Stroud & Co.

Irrigated Lands Co., Ltd.

Twin Falls, Idaho

OFFICE, NORTH-WING HOTEL PERRINE.

Money to Loan on Improved Farms.
Real Estate. Insurance.
Investments made for Non-Residents. The Benefits of 20
Years' Experience in Farming by Irrigation at the
Service of our Customers.

A. McPHERSON.

GEO. F. SPRAGUE.

Twin Falls, Idaho.

McCORNICK & CO., Bankers

Branch of McCornick & Co., Salt Lake

Transact a General Banking Business

TWIN FALLS, IDAHO

NEW MEAT MARKET

Now Open

We have just opened a new meat market in the Messer Block on Main street just above the Hotel Perrine. We carry the best of everything in the way of meats and solicit a share of your patronage. Our phone number is 162.

F. J. TERRILL & SON.

THE FARMERS CORRAL

Livery, Feed and Sale Stable

HORSES BOUGHT AND SOLD.

GOOD FEEDING CORRAL.

PHONE 35.

D. A. SEAMAN, Proprietor.

SORE ON RECLAMATION SERVICE

Minidoka Settlers Resent Nonsensical Ruling.

When will a restraining hand be laid upon the insane efforts of the Interior department to make life intolerable for a reclamation project settler? When will reason and justice mark the policy of Washington officials in handling reclamation problems? When will even a superficial knowledge of conditions upon these projects, a faint glimmer of intelligence, or a diminutive degree of fairness be admitted to the intellect and the conscience of the bureaucrats? God speed the day!

We have at hand the latest deliverance of the commissioner of the general land office, who rules that a settler on a reclamation project cannot make payment in full for his water right until he has made five annual payments. This means that the settler under the pumping system of the Minidoka project, who will have completed his five-year term of residence before the first water payment becomes due, will be required to wait five years longer for his title. On this side of the river it will yet be four years before patent can be acquired to an acre of land, notwithstanding many of the settlers have at this time put in four years on their claims.

A more unjust, unwarranted, nonsensical rule than this scarcely could be conceived. It is a complete subversion of the homestead act, a misinterpretation of the reclamation act itself. The framers of this act never intended that settlers who took advantage of its provisions should be forced to wait 10 years for title to their lands, if they were able and willing to pay for their water rights within a shorter period. Could the authors of the reclamation act have foreseen the vagaries and eccentricities that have characterized the administration of this law, they would have given the settler some protection by marking out an explicit and detailed plan of procedure.

The commissioner places the responsibility upon the secretary of the Interior, declaring that the secretary must modify his order before any other rule can be permitted. So much the worse for the secretary. The condition thus created is prejudicial alike to the interests of the settlers and the government. Certainly it is to the advantage of the government that this money be repaid as soon as possible, for the reclamation funds are depleted and other projects are clamoring for more. And certainly it is to the interest of the settler to acquire title at the end of five years residence. Hence, the rule is an injustice, both to the settler and to the government. Quite in line with this absurd policy is the letter from the secretary of the Interior, published elsewhere in this issue. This letter relates to the public notice given by Secretary Hitchcock in 1904, to the effect that the first water payment would be due in December of the year in which

water was delivered in April. After lightly brushing aside this notice, as a "tentative" document, and not binding upon the government in any way, Secretary Garfield goes on to say that "the conditions in March, 1907, were such that there was a certainty that water would be furnished sufficiently early in the irrigation season to admit of the raising of at least one crop. That such condition was realized is not disputed."

How does that strike you, you farmers who fully six months prior to the non-delivery of water in time to save it? It certainly is the limit, in face of the fact that, had it not been for exceptional soil conditions on some portions of the tract and a most extraordinary rainfall, not a bushel of grain would have been raised on the project last year. And the secretary declares it is "not disputed" that water was furnished in ample time, when it is directly disputed by scores of affidavits now on file in his own department.

Further along the secretary says: "The settlers had no reason to doubt that they would be able to harvest their crops if they properly prepared and cultivated their land. This report shows few cases of failure, when the land was thus prepared, seeded and carefully cultivated."

The truth is that the settlers generally fully six months prior to the opening of the irrigation season of last year knew that it would be a physical impossibility to deliver water in time to mature a full crop, and for that reason many of them declined to waste money by putting in a crop. We are curious to know the source of those "reports" upon which the secretary relies. Show us their origin and we will guarantee to produce a pho dreamer.

This letter from Secretary Garfield simply reveals the appalling ignorance that prevails in the Interior department concerning actual facts and conditions here, an ignorance that explains but does not excuse a long record of blunders. It may be that our secretary means well. We will not deny that. But he is in tremendous need of more light.

It may yet become necessary for the settlers to approach this question with a big stick—Rupert Pioneer Record.

Berkshire and Poland China pigs, pure bred, for sale at Maple Hill farm, 2 1/2 miles southwest of Twin Falls. T. W. Potter.

Eggs for Setting.
Silver laced Wyandottes, \$1.50 for 15. Inquire Booth's Dry Goods Co., Twin Falls.

FOR SALE OR RENT—Two farms near Buhl, one 150 acres, the other 160. Will sell or make satisfactory arrangements for leasing. Address E. V. Asay, 4320 Drexel Boulevard Chicago, Ill.

If you want to sell, see Carter, Clear & Wright. If you want to buy, see Carter, Clear & Wright.

Sprague's Pharmacy

Drugs WHAT IS THAT YOU WANT?

Rubber Goods

Useful Presents

Goods of Best Quality

See Us Before Buying

NEXT TO P. O.

TWIN FALLS, IDAHO.

The BEST of Groceries

is none too good for any family. Trading with us insures your getting the very best grade of groceries that the market produces, and the prompt filling and delivery of all orders.

No order is too small to receive our attention.

Perrine & Burton

General Merchandise

F. F. JOHNSON, President.

S. H. MAYS, Vice Pres.

First National Bank of Twin Falls

J. M. MAXWELL, Cashier.

CAPITAL STOCK \$40,000.00

General Banking Business Transacted

Safety Deposit Boxes for Rent

COR. MAIN ST. AND SHOSHONE AVE. TWIN FALLS

INTRODUCTORY SALE

Wholesale Representatives to Assist in Disposing of Initial Stock of Lavering's Fine Pianos and Organs, Beginning

MONDAY, MAY 18, 1908

For ten days all the beautiful stock will be offered at positively wholesale prices by Mr. F. A. Raymond and Mr. A. O. Jones, wholesale representatives, to introduce this splendid line and acquaint the Twin Falls public with the EILERS PIANO HOUSE and their line of goods known as the "Line of Highest Quality".

At Your Own Terms

SEE OUR EASY PAYMENT PLAN

E. C. LAVERING

FINEST PIANOS, ORGANS AND FURNITURE